



# RAILROAD COMMISSION OF TEXAS

## OIL AND GAS DIVISION

July 1, 2015

Unidentified Operator

### STATUS REPORT

#### **Murray, Cody Complaint No. 7B-10736**

Murray Property  
Murray Water Well  
Palo Pinto County, Texas  
Job No. 14-9803

Cody Murray's initial concern was a flash fire originating from his water well possibly caused by oil and gas activities. File review conducted on June 30, 2015, by Gene Ortiz revealed the following:

On August 21, 2014, water samples from the Murray water well were collected by RRC contractor Terracon. The operators of surrounding oil and gas leases have collected gas samples from their wells to determine if oil and gas operations contributed to the flash fire which occurred on August 2, 2014, from the Murray water well. A review of the analytical data was issued by the Site Remediation Section.

On April 28, 2015, the district office requested the operators of surrounding wells to provide the RRC additional information. Information provided (well chronology reports, mud log, density logs, etc.) by Fairway Resources Operating, LLC (259788) and EOG Resources, Inc. (253162) are currently still being reviewed by the RRC staff.

On June 22 and June 23, 2015, inspections were conducted of the oil and gas wells in the immediate vicinity of the study area. During the inspections, no pressure was observed on the bradenhead of any of the inspected wells. On June 23, 2015, access to the Cook, J. T. lease (RRC lease no. 020983) was not gained; however, a back check inspection will be conducted to observe any pressure on the bradenhead.

A review of the cementing records and the well chronology reports noted discrepancies regarding the setting of the surface casing; however, there is no indication that surface casing was not set to protect the base of usable quality water during the setting of the surface casing on any of the wells inspected in the immediate vicinity. In addition, all records indicate cement was circulated to the ground surface. These discrepancies were noted on well no. 1H of the Singleton lease (RRC lease no. 274030) and well no. 2H of the Singleton lease (RRC lease no. 274031), both operated by EOG Resources, Inc. (253162) and located approximately 1000 feet north-northeast of the Murray water well. On June 22, 2015, certified correspondence was issued to the operator citing the violations of SWR 16 (Log and Completion or Plugging Report) for both leases.

File review is scheduled for the week of August 10, 2015.

Page 2  
Murray, Cody Complaint 7B-10736  
Unidentified  
Murray Water Well  
Palo Pinto County, Texas  
July 1, 2015

**Please direct any questions with regard to this complaint to Gene Ortiz at (325)-677-3545.**

Sincerely,

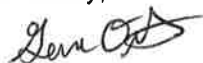

Gene Ortiz  
Engineering Specialist

GO/mm

- ☒ Assistant District Director  
☐ District Director

cc: Field Operations, RRC, Austin

Cody Murray  
PO Box 164  
Perrin, TX 76486

Peter Pope, Site Remediation  
RRC - Austin

## Gene Ortiz

---

**From:** Peter Pope  
**Sent:** Thursday, June 18, 2015 8:49 AM  
**To:** Gene Ortiz  
**Subject:** RE: Attached Image - Singleton, Murray Complaints, Palo Pinto Co.

Thank you.

---

**From:** Gene Ortiz  
**Sent:** Thursday, June 18, 2015 8:34 AM  
**To:** Peter Pope  
**Subject:** RE: Attached Image - Singleton, Murray Complaints, Palo Pinto Co.

Peter,

EOG sent the Well Chronology Reports (attached) for 8 of their wells. They also sent in resistivity/density logs for most of the wells.

Fairway sent the Company Drilling Reports, IADC Reports, and Mud Logs on their wells, however, they stated that the well files were incomplete.

I will mail you the information from Fairway and the logs EOG sent.

---

**From:** Peter Pope  
**Sent:** Wednesday, June 17, 2015 4:56 PM  
**To:** Gene Ortiz  
**Subject:** FW: Attached Image - Singleton, Murray Complaints, Palo Pinto Co.

Gene:

Any reply from the operators about these letters? I would appreciate an opportunity to look through their well files. Thanks,

Peter

---

**From:** [Canon-A1@rrc.state.tx.us](mailto:Canon-A1@rrc.state.tx.us) [mailto:Canon-A1@rrc.state.tx.us]  
**Sent:** Wednesday, June 17, 2015 5:05 PM  
**To:** Peter Pope  
**Subject:** Attached Image

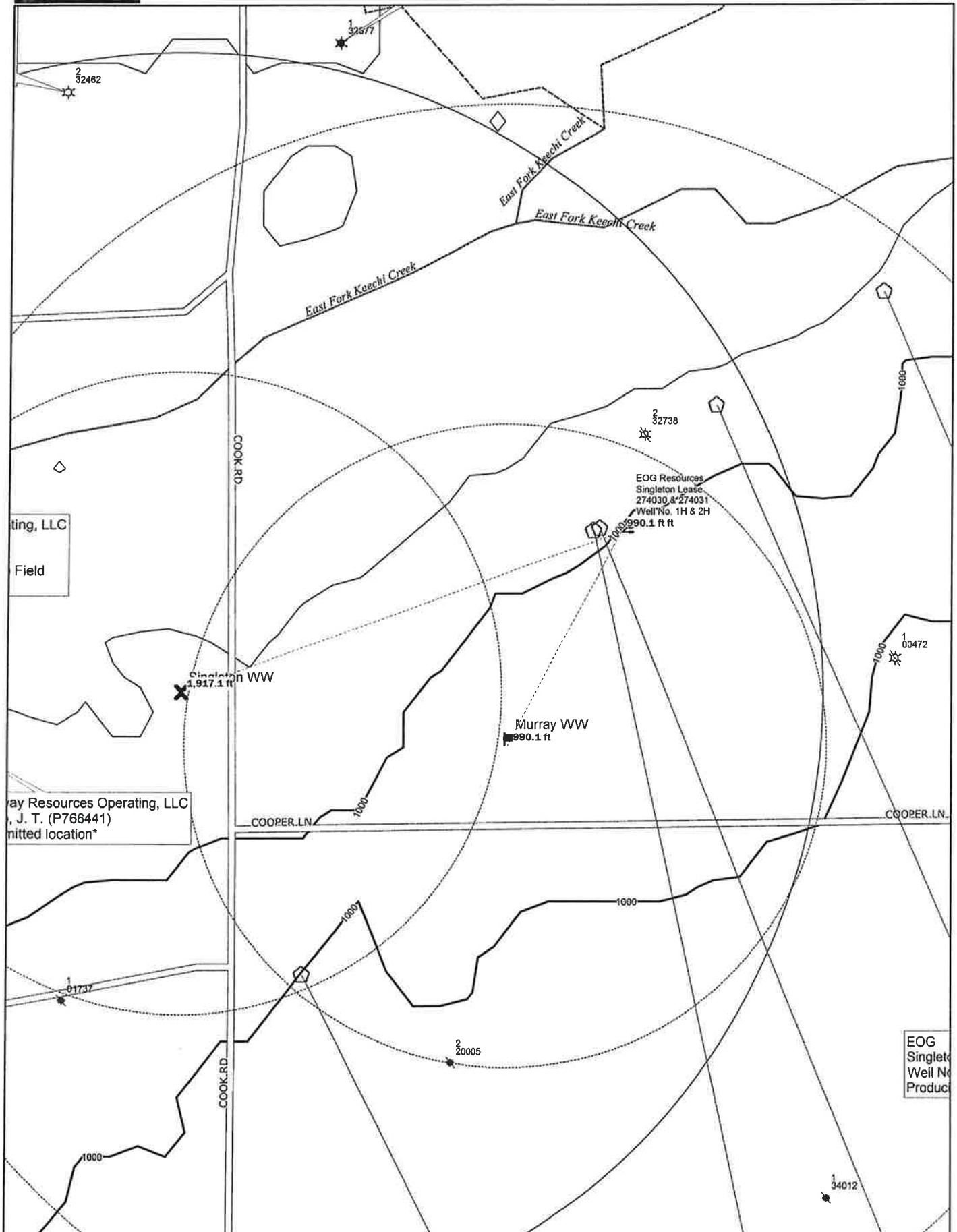

Data use subject to license.

© DeLorme. XMap® 6.

www.delorme.com

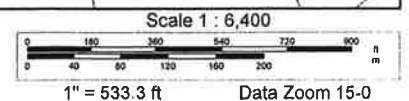

CHRISTI CRADDICK, CHAIRMAN  
DAVID PORTER, COMMISSIONER  
RYAN SITTON, COMMISSIONER



LORI WROTENBERY  
DIRECTOR, OIL AND GAS DIVISION  
D. W. -JOE- CRESS  
DISTRICT DIRECTOR

# RAILROAD COMMISSION OF TEXAS

## OIL AND GAS DIVISION

May 8, 2015

Unidentified Operator

### STATUS REPORT

#### **Murray, Cody Complaint No. 7B-10736**

Murray Property  
Murray Water Well  
Palo Pinto County, Texas  
Job No. 14-9803

Cody Murray's initial concern was a flash fire originating from his water well possibly caused by oil and gas activities. File review conducted on February 19, 2015, by Gene Ortiz revealed the following:

On August 21, 2014, water samples from the Murray water well were collected by RRC contractor Terracon. The operators of surrounding oil and gas leases have collected gas samples from their wells to determine if oil and gas operations contributed to the flash fire which occurred on August 2, 2014, from the Murray water well. A review of the analytical data was issued by the Site Remediation Section.

On April 28, 2015, the district office requested the operators of surrounding wells to provide the driller's log of the wells. Once received, the district office will review the driller's log and conduct a further detailed review of well construction records of the oil and gas wells in the immediate vicinity of the study area.

File review is scheduled for the week of June 22, 2015. **Please direct any questions with regard to this complaint to Gene Ortiz at (325)-677-3545.**

Sincerely,

A handwritten signature in black ink, appearing to read "Gene Ortiz".

Gene Ortiz  
Engineering Specialist

GO/mm/cz

- ☒ Assistant District Director  
☐ District Director

cc: Field Operations, RRC, Austin

Cody Murray  
PO Box 164  
Perrin, TX 76486

Peter Pope  
Site Remediation  
RRC - Austin

## Site Remediation Section

### Railroad Commission of Texas

#### Review of Analytical Data - Murray Complaint (7B-10736) and Singleton Complaint (7B-10612)

April 28, 2015

#### **Background**

On February 20, 2014, the Railroad Commission of Texas (RRC) District 7B office was contacted by Mr. Richard Singleton regarding the smell of gas from his water well. An initial inspection was performed on the 20<sup>th</sup> of February. Subsequent sampling and analysis of water from his well in April 2014 confirmed the presence of methane in the water sample from his well. The Singleton Complaint was assigned Complaint No. 7B-10612. On August 2, 2014, Mr. Cody Murray contacted the RRC District 7B office regarding a flash fire that originated from his water well. An initial inspection was performed on the 2<sup>nd</sup> of August. The Murray Complaint was assigned Complaint No. 7B-10736. Both homes are located within 1,400 feet of each other in northeastern Palo Pinto County.

On August 7, 2014, District Office staff visited homes within a one-mile radius of the Singleton and Murray properties to leave packets of information with a request to sample water wells. One person responded. Consequently, commission staff initiated a plan to collect water samples from the Murray and Singleton water wells, and additional water wells if permission could eventually be obtained.

On August 21, 2014, Terracon, on behalf of the RRC, collected groundwater samples from the Singleton and Murray water wells. During and subsequent to that sampling event, RRC staff made arrangements to sample three additional water wells in the general area. The three additional water wells (identified as Parker, Mills and Hill) were sampled on August 28, 2014. Groundwater samples were analyzed for dissolved methane, ethane, and propane, total petroleum hydrocarbons (TPH), benzene, toluene, ethylbenzene, and xylenes (BTEX), chloride and sulfide. Samples were also analyzed for natural gas composition and carbon and hydrogen isotopes of methane, ethane and propane.

Water wells were purged for several minutes prior to sampling. The Hill property water well, however, was not purged due to low well yield. Water samples were collected using low flow sampling techniques from the wellhead spigot, or as close to the wellhead as possible. Samples for BTEX, TPH, sulfide and chloride analyses were collected in 40 ml VOA vials and 250 ml plastic containers. Samples for dissolved gas concentration, composition, and isotopes were collected using IsoFlask technology.

Copies of the water well sampling reports were submitted to the five property owners in separate correspondence dated October 20, 2014.

In addition to the dissolved gas samples from water wells, Commission staff requested from operators (EOG and Fairway Resources) sampling and analysis of gas samples from nearby oil and gas production wells.

A figure depicting the locations of water wells and oil and gas production wells sampled for this study is attached as Figure 1. Information about water well construction is provided in Table 1. The oil and gas production wells in the area are producing from the Barnett Shale, at a depth of approximately 5100'-5500' and from shallower fields including the KRS (Marble Falls) and Palo Pinto Co. Regular fields, at depths of approximately 4600'-4900' and 3190'-3210', respectively. The water wells are completed at depths ranging from 190' to 220' depth.

Based on a review of geological studies in the area, the study area is within the outcrop of the Pennsylvanian Canyon Group, which has been described as a sequence of carbonate and terrigenous clastic rocks deposited in a generally carbonate- and mud-rich environment (Nicot, J.P., et al., 2013, Brown, et al., 1973). Limestones of the Palo Pinto Formation (within the Canyon Group) are reported to be water-bearing with accessible water present mostly in fractures (Nicot, J.P., et al., 2013).

### **Review of Analytical Data**

Data summary tables and plots of isotope analyses are attached. Dissolved constituent data are presented in Table 2. Sulfide (a test for the occurrence of hydrogen sulfide gas) was not detected in any water well sample. Chloride was detected in each well in concentrations ranging from 230 mg/L to 1,060 mg/L. TPH, ethylbenzene, and xylenes were not detected in any sample. Benzene and toluene were detected in only one water well (Singleton) at concentrations of 0.009 mg/L and 0.0007 mg/L, respectively. Dissolved methane, ethane and propane were detected in each water well. Methane concentrations ranged from 0.0014 mg/L (Parker) to 55 mg/L (Mills). Ethane ranged from 0.0002 mg/L (Parker) to 13 mg/L (Mills). Propane ranged from 0.0002 mg/L (Parker) to 6.9 mg/L (Mills). The presence of ethane and propane suggest that the gas is thermogenic in origin, rather than biogenic.

The gas composition and isotope data from the water wells and production wells are presented in Tables 3 and 4, respectively. Isotope and composition ratio data are graphically presented on four separate graphs (attached) to further evaluate the source of the gas and to look for similarities or differences in groups of samples. The Parker water well did not contain enough gas to analyze for isotopes. Samples from two of the EOG wells were analyzed for gas composition only.



A plot of hydrogen (deuterium) vs. carbon isotopes of methane (Figure 2) confirms that the gas is thermogenic in origin. When plotted on a finer scale (Figure 3), the data appear to cluster such that the water well isotope data plot in a unique area and production gas isotopes reveal greater variability. A plot of wetness (i.e., the ratio of methane [C1] to the sum of heavier gases [C2+C3]) vs. carbon isotope of methane and a plot of carbon isotope of ethane vs. the ratio of methane to ethane content are presented as Figures 4 and 5, respectively. Collectively, Figures 3, 4, and 5, reveal a separation between production gas and water well gas. However, the separation appears more distinct for Barnett Shale gas than for the gas produced from the Palo Pinto Co. Regular and KRS (Marble Falls) fields.

Therefore, while the data appear to suggest that the gas in groundwater is not migrating directly from the Barnett Shale into the water wells, the data are inconclusive with respect to specific migration pathways from shallower sources. Furthermore, the natural occurrence of shallow gas (less than 500 feet deep) and natural gas seeps in Palo Pinto County have been documented in earlier reports (Wegemann, 1915).

#### **Recommendations**

Based on the information described above, staff recommends further detailed review of well construction records for oil and gas production wells in the immediate vicinity of the study area, to include a detailed review of cementing records and monitoring of bradenhead pressure gauges to ensure that producing wells in the area are sufficiently cemented to isolate groundwater from underlying producing formations.

Peter G. Pope, P.G.





## References:

Brown, L.F. Jr., et al., 1973, Pennsylvanian Depositional Systems in North-Central Texas: A Guide for Interpreting Terrigenous Clastic Facies in a Cratonic Basin, Guidebook Number 14, Prepared for the Annual Meeting of the Geological Society of America, November, 1973. Bureau of Economic Geology.

Nicot, J.P, et al., 2013, Flow and Salinity Patterns in the Low-Transmissivity Upper Paleozoic Aquifers of North-Central Texas, GCAGS Journal, v.2 (2013) p. 53-67.

Terracon, 2014, Water Well Sampling – Hill Property, Report Prepared for the Railroad Commission of Texas, October 16, 2014.

Terracon, 2014, Water Well Sampling – Mills Property, Report Prepared for the Railroad Commission of Texas, October 16, 2014.

Terracon, 2014, Water Well Sampling – Murray Property, Report Prepared for the Railroad Commission of Texas, October 16, 2014.

Terracon, 2014, Water Well Sampling – Parker Property, Report Prepared for the Railroad Commission of Texas, October 16, 2014.

Terracon, 2014, Water Well Sampling – Singleton Property, Report Prepared for the Railroad Commission of Texas, October 16, 2014.

Wegemann, Carroll H., 1915, A Reconnaissance in Palo Pinto County, Texas, With Special Reference to Oil and Gas, *Contributions to Economic Geology*, 1915, Part II.

**Table 1**  
**Water Well Construction Information**  
**Murray and Singleton Water Well Complaint Investigation Area**  
**Palo Pinto County, Texas**

Well ID.	Total Depth (ft)	Screened Interval (ft)	Gravel Pack (ft)
Murray Well	220	160-180 & 200-220	100-220
Singleton Well	210	NA	NA
Hill Well	190	NA	NA
Mills Well	200	NA	NA
Parker Well	220	160-180 & 200-220	10-220

NA = information not available

Table 2  
Summary of Dissolved Concentration Data - Water Wells  
Murray and Singleton Water Well Complaint Investigation Area  
Palo Pinto County, Texas

Sample	Date	Methane	Ethane	Propane	Benzene	Toluene	Ethylbenzene	Xylenes	TPH C6-C12	TPH C12-C35	TPH C6-C35	Chloride	Sulfide
		mg/L	mg/L	mg/L	mg/L	mg/L	mg/L	mg/L	mg/L	mg/L	mg/L	mg/L	mg/L
Murray Well	8/21/2014	14.0	3.30	1.70	ND	ND	ND	ND	ND	ND	ND	294	<0.106
Singleton Well	8/21/2014	38.0	10.00	6.10	0.009	0.001	ND	ND	ND	ND	ND	1060	<0.106
Hill Well	8/28/2014	2.40	0.24	0.03	ND	ND	ND	ND	ND	ND	ND	373	<0.106
Mills Well	8/28/2014	55.0	13.00	6.90	ND	ND	ND	ND	ND	ND	ND	230	<0.106
Parker Well	8/28/2014	0.0014	0.0002	0.0002	ND	ND	ND	ND	ND	ND	ND	755	<0.106

ND = not detected

Table 3  
Summary of Water Well Gas Data  
Murray and Singleton Water Well Complaint Investigation Area  
Palo Pinto County, Texas

Sample	Media	Date	Compositional Analysis															Isotope Analysis			
			Helium	Hydrogen	Argon	Oxygen	Nitrogen	Carbon Dioxide	Carbon Monoxide	Methane	Ethane	Propane	iso-Butane	n-Butane	iso-Pentane	n-Pentane	Hexane+	Methane	Methane	Ethane	Propane
			He	H <sub>2</sub>	Ar	O <sub>2</sub>	N <sub>2</sub>	CO <sub>2</sub>	CO	CH <sub>4</sub>	C <sub>2</sub> H <sub>6</sub>	C <sub>3</sub> H <sub>8</sub>	IC <sub>4</sub> H <sub>10</sub>	nC <sub>4</sub> H <sub>10</sub>	IC <sub>5</sub> H <sub>12</sub>	nC <sub>5</sub> H <sub>12</sub>	C <sub>6</sub> +	δ <sup>13</sup> C <sub>1</sub>	δD <sub>1</sub>	δ <sup>13</sup> C <sub>2</sub>	δ <sup>13</sup> C <sub>3</sub>
			%	%	%	%	%	%	%	%	%	%	%	%	%	%	%	‰	‰	‰	‰
Murray Well	Water	8/21/2014	—	nd	0.815	1.37	42.47	0.94	nd	46.51	5.33	2	0.159	0.315	0.0402	0.0309	0.0179	-45.98	-191.5	-34.61	-29.01
Singleton Well	Water	8/21/2014	—	nd	0.332	0.037	19.42	0.77	nd	65.73	8.9	3.78	0.327	0.551	0.0953	0.0223	0.0326	-46.11	-192.9	-34.67	-28.84
Hill Well	Water	8/28/2014	—	nd	1.49	2.53	80.33	2.59	nd	12.41	0.58	0.0533	0.0091	0.0079	0.002	0.0008	0.0004	-45.69	-194	-30.2	—
Mills Well	Water	8/28/2014	—	nd	0.122	0.51	5.91	0.3	nd	79.73	8.94	3.55	0.0306	0.494	0.0615	0.0357	0.0099	-45.96	-194.6	-34.34	-28.79
Parker Well	Water	8/28/2014	—	nd	1.37	15.08	71.78	11.76	nd	0.0062	0.0003	nd	nd	nd	nd	nd	nd	—	—	—	—

— = not analyzed  
nd = not detected  
‰ = per mil  
% = mol %

**Table 4**  
**Summary of Production Well Gas Data**  
**Murray and Singleton Water Well Complaint Investigation Area**  
**Palo Pinto County, Texas**

Sample	Laboratory	Date	Compositional Analysis															Isotopic Analysis				
			Helium	Hydrogen	Argon	Oxygen	Carbon Dioxide	Nitrogen	Methane	Ethane	Propane	iso-Butane	n-Butane	iso-Pentane	n-Pentane	Hexane	Methane	Ethane	Propane			
			He	H <sub>2</sub>	Ar	O <sub>2</sub>	CO <sub>2</sub>	N <sub>2</sub>	CH <sub>4</sub>	C <sub>2</sub> H <sub>6</sub>	C <sub>3</sub> H <sub>8</sub>	iC <sub>4</sub> H <sub>10</sub>	nC <sub>4</sub> H <sub>10</sub>	iC <sub>5</sub> H <sub>12</sub>	nC <sub>5</sub> H <sub>12</sub>	C <sub>6</sub> H <sub>14</sub>	δ <sup>13</sup> C <sub>1</sub>	δD <sub>1</sub>	δ <sup>13</sup> C <sub>2</sub>	δ <sup>13</sup> C <sub>3</sub>		
Singleton #1	SPL	9/5/2014	0.042	0.012	—	0.063	0.516	1.715	77.156	12.267	5.089	0.522	1.375	0.294	0.368	0.581	—	—	—	—		
Singleton #1H	Isotech	9/5/2014	0.0823	0.014	0.005	nd	0.49	1.51	76.78	12.87	5.18	0.522	1.38	0.291	0.364	0.511	-46.79	-207.9	-37.91	-33.09		
Singleton #2	SPL	9/5/2014	0.043	0.007	—	nd	0.51	1.523	77.221	12.292	5.141	0.532	1.406	0.304	0.381	0.64	—	—	—	—		
Singleton #3	SPL	9/5/2014	0.042	0.105	—	0.021	0.553	1.673	77.792	11.897	4.807	0.495	1.322	0.29	0.37	0.633	—	—	—	—		
Singleton #3H	Isotech	9/5/2014	0.0787	0.0766	0.0144	0.16	0.59	2.54	75.89	12.48	5.05	0.51	1.37	0.296	0.376	0.562	-44.51	-202.5	-37.51	-33.21		
Singleton #4	SPL	9/5/2014	0.042	0.042	—	0.042	0.559	1.719	77.368	12.172	4.933	0.506	1.339	0.289	0.369	0.62	—	—	—	—		
Singleton #4H	Isotech	9/5/2014	0.0872	0.0358	0.0054	nd	0.54	1.55	76.83	12.71	5.12	0.516	1.37	0.294	0.37	0.573	-46.69	-207	-37.93	-33.16		
Singleton #5	SPL	9/5/2014	0.043	0.006	—	0.021	0.466	1.509	76.892	12.426	5.139	0.539	1.338	0.315	0.402	0.794	—	—	—	—		
Singleton B Unit #1H	SPL	9/5/2014	0.042	0.105	—	nd	0.566	1.653	77.939	11.878	4.754	0.487	1.305	0.285	0.367	0.619	—	—	—	—		
Singleton B Unit #1H	Isotech	9/5/2014	0.0921	0.119	0.006	nd	0.5	1.65	77.22	12.41	4.98	0.5	1.34	0.289	0.366	0.529	-46.86	-205.5	-38.36	-33.66		
Singleton B Unit #2H	SPL	9/5/2014	0.042	0.022	—	0.021	0.523	1.688	77.804	11.945	4.847	0.485	1.323	0.289	0.369	0.632	—	—	—	—		
Singleton B Unit #2H	Isotech	9/5/2014	0.0896	0.0252	0.0086	0.036	0.5	1.94	77.08	12.45	4.95	0.493	1.32	0.281	0.354	0.468	-46.86	-207	-38.39	-33.83		
Singleton B Unit #3H	SPL	9/5/2014	0.042	0.021	—	nd	0.51	1.636	77.79	11.831	4.955	0.505	1.359	0.296	0.383	0.669	—	—	—	—		
Singleton B Unit #3H	Isotech	9/5/2014	0.0859	0.0238	0.0171	0.24	0.53	2.81	76.06	12.37	4.92	0.492	1.31	0.28	0.357	0.504	-45.89	-202.7	-38.04	-33.5		
Singleton B Unit #4H	SPL	9/5/2014	0.043	0.006	—	0.021	0.53	1.604	76.926	12.092	5.188	0.547	1.473	0.328	0.418	0.824	—	—	—	—		
Singleton B Unit #4H	Isotech	9/5/2014	0.0792	nd	0.0087	0.1	0.52	2.03	75.78	12.81	5.3	0.544	1.47	0.321	0.405	0.635	-45.58	-204.9	-37.79	-33.18		
Singleton B Unit #5H	SPL	9/5/2014	0.043	0.01	—	0.021	0.594	1.504	77.084	12.191	5.088	0.521	1.444	0.318	0.417	0.765	—	—	—	—		
Singleton B Unit #5H	Isotech	9/5/2014	0.0881	0.0108	0.0057	0.029	0.57	1.56	76.43	12.8	5.23	0.524	1.45	0.311	0.403	0.586	-46.94	-202.2	-38.7	-34.06		
JT Cook 2	Isotech	9/9/2014	0.0749	nd	nd	nd	0.14	1.73	76.62	12.70	5.46	0.604	1.43	0.304	0.358	0.576	-46.51	-204.8	-36.23	-30.54		
JT Cook A-1	Isotech	9/9/2014	0.185	nd	0.0101	nd	0.14	4.47	83.36	5.34	3.85	0.653	1.10	0.257	0.221	0.415	-47.26	-187.7	-35.27	-31.88		

— = not analyzed  
nd = not detected  
% = per mil  
% = mol %





# Stable carbon and hydrogen isotopic composition ranges of methanes from different sources

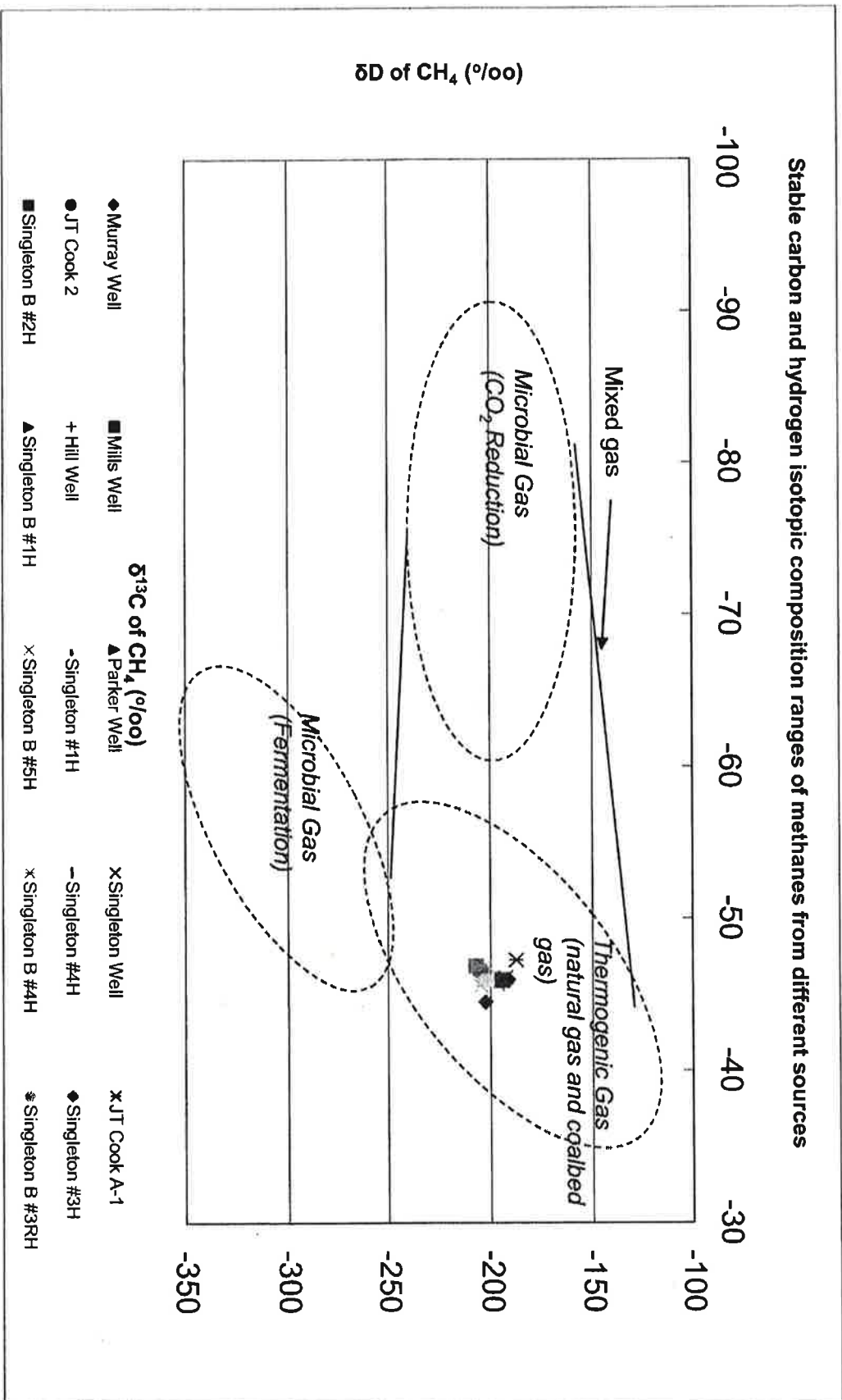

Figure 2



# **Stable carbon and hydrogen isotopic composition ranges of methanes from different sources**

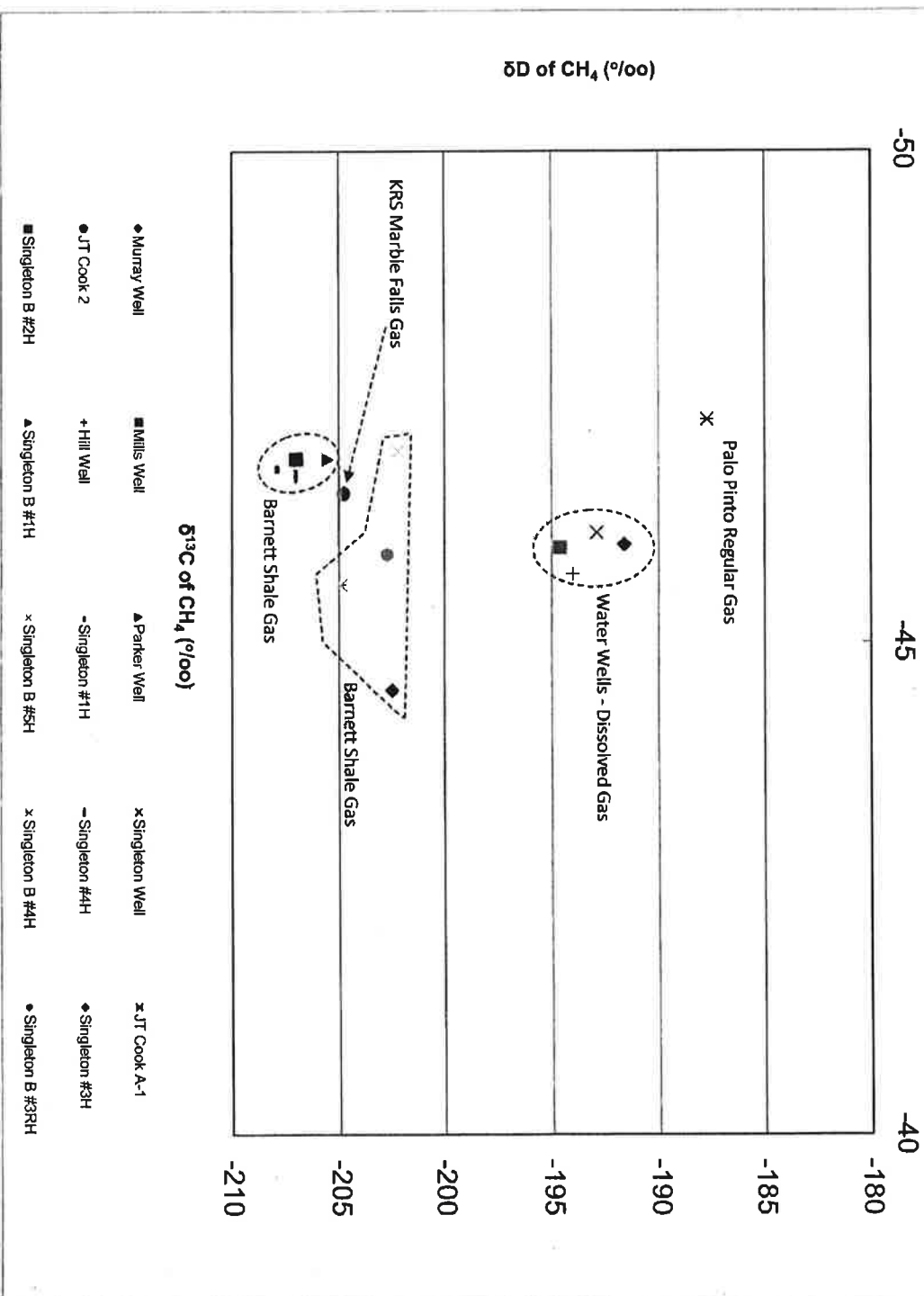

Figure 3

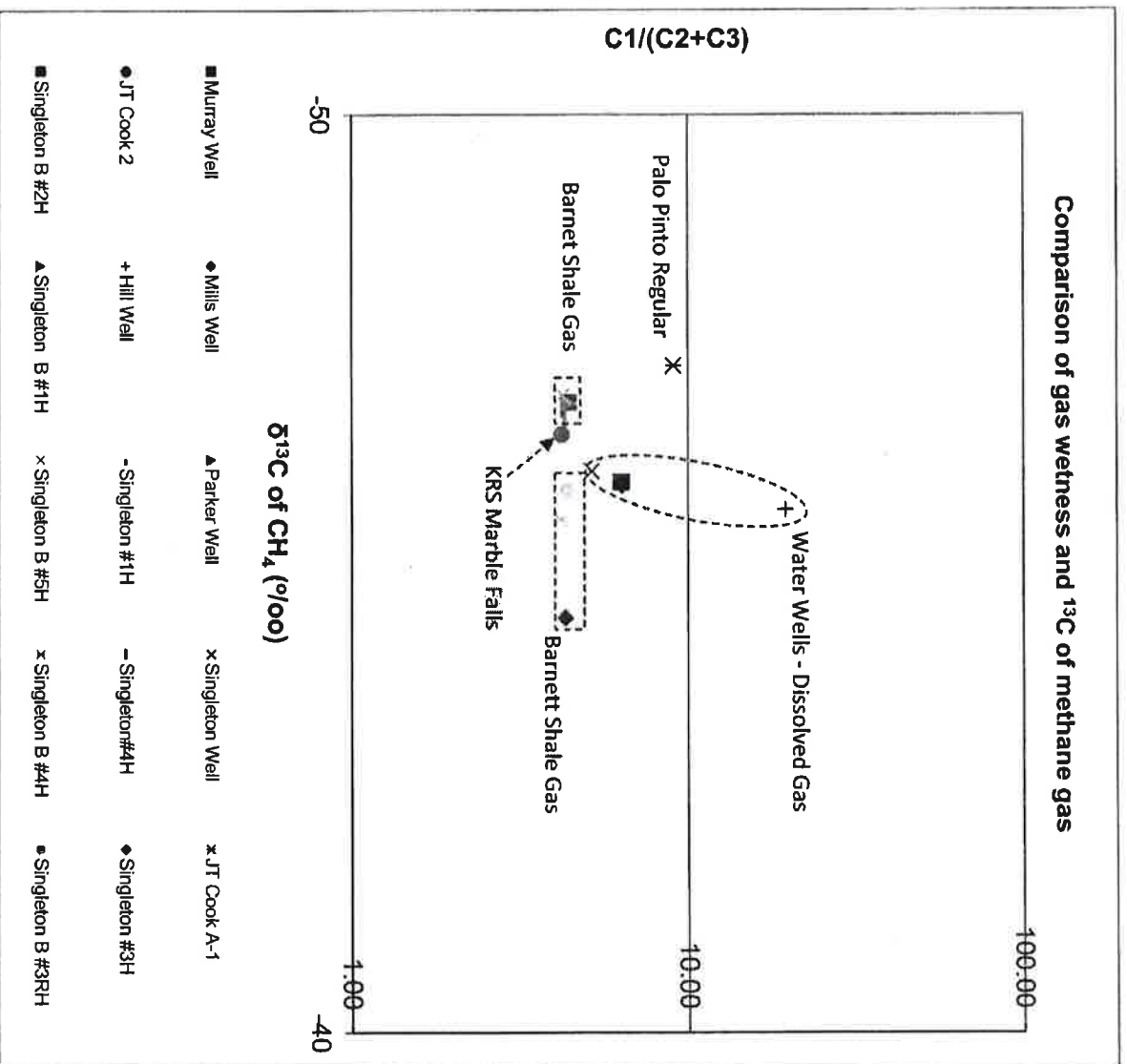

Figure 4

# Carbon Isotope of Ethane vs. Methane/Ethane Ratio

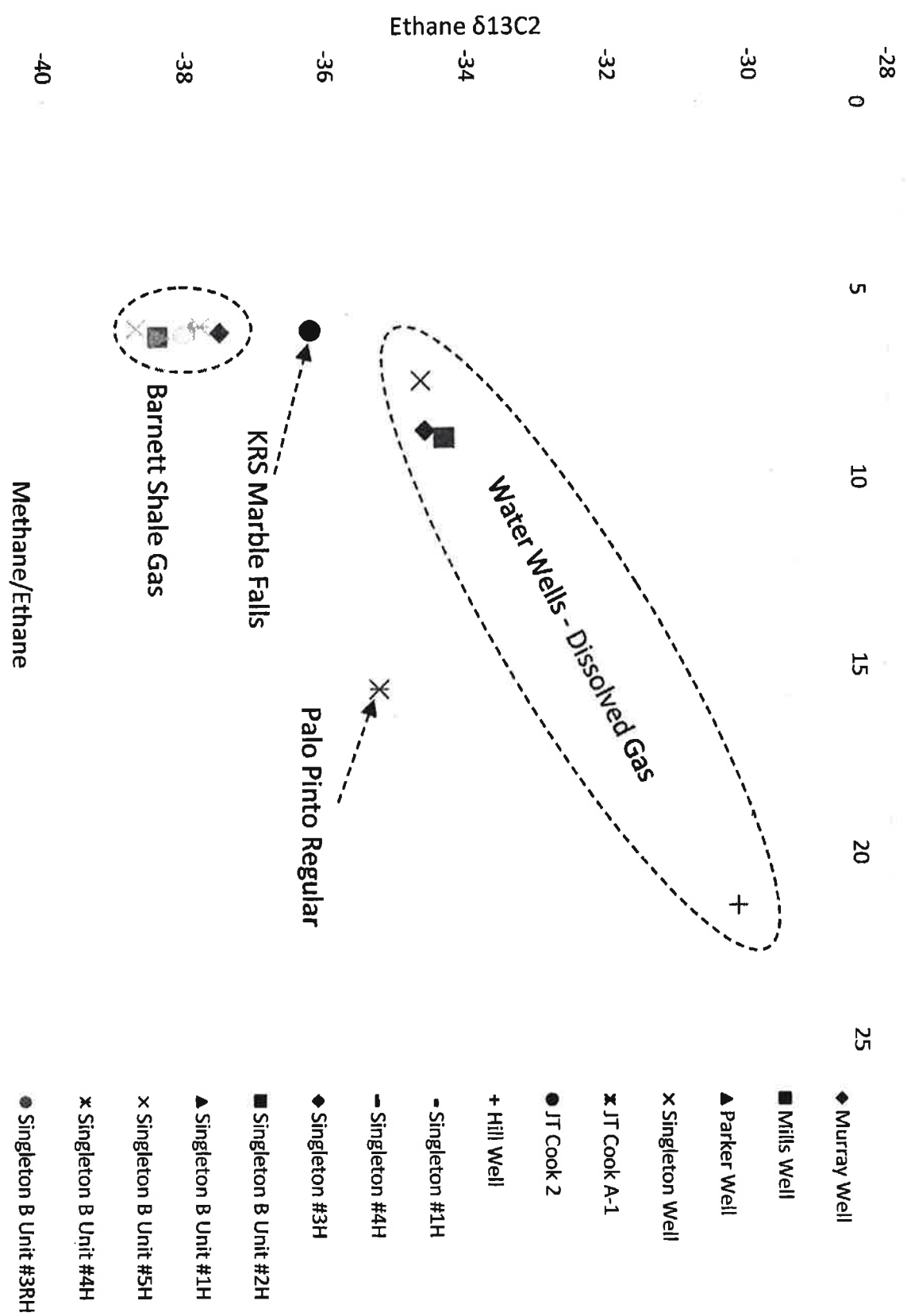

Figure 5

CHRISTI CRADDICK, CHAIRMAN  
DAVID PORTER, COMMISSIONER  
RYAN SITTON, COMMISSIONER



LORI WROTENBERY  
DIRECTOR, OIL AND GAS DIVISION  
D. W. -JOE- CRESS  
DISTRICT DIRECTOR

# RAILROAD COMMISSION OF TEXAS

## OIL AND GAS DIVISION

February 20, 2015

Unidentified Operator

### STATUS REPORT

#### **Murray, Cody Complaint No. 7B-10736**

Murray Property  
Murray Water Well  
Palo Pinto County, Texas  
Job No. 14-9803

Cody Murray's initial concern was a flash fire originating from his water well possibly caused by oil and gas activities. File review conducted on February 19, 2015, by Gene Ortiz revealed the following:

On August 21, 2014, water samples from the Murray water well were collected by RRC contractor Terracon. The operators of surrounding oil and gas leases have collected gas samples from their wells to determine if oil and gas operations contributed to the flash fire which occurred on August 2, 2014, from the Murray water well. At this time, the RRC awaits complete results of the water and gas samples.

The complainant is advised that the Site Remediation Department continues to work alongside the District Office in determining whether oil and gas operations contributed to the flash fire originating from the Murray water well.

File review is scheduled for the week of April 27, 2015. **Please direct any questions with regard to this complaint to Gene Ortiz at (325)-677-3545.**

Sincerely,

A handwritten signature in black ink, appearing to read "Gene Ortiz".

Gene Ortiz  
Engineering Specialist

GO/mm/cz

- ☒ Assistant District Director  
☐ District Director

cc: Field Operations, RRC, Austin

Cody Murray  
PO Box 164  
Perrin, TX 76486

Peter Pope  
Site Remediation  
RRC - Austin

CHRISTI CRADDICK, CHAIRMAN  
DAVID PORTER, COMMISSIONER  
BARRY T. SMITHERMAN, COMMISSIONER



TIMOTHY A. POE  
ACTING DIRECTOR, OIL AND GAS DIVISION  
D. W. -JOE- CRESS  
DISTRICT DIRECTOR

# RAILROAD COMMISSION OF TEXAS

## OIL AND GAS DIVISION

December 5, 2014

Unidentified Operator

### STATUS REPORT

#### **Murray, Cody Complaint No. 7B-10736**

Murray Property  
Murray Water Well  
Palo Pinto County, Texas  
Job No. 14-9803

Cody Murray's initial concern was a flash fire originating from his water well possibly caused by oil and gas activities. File review conducted on October 13, 2014, by Gene Ortiz revealed the following:

On August 21, 2014, water samples from the Murray water well were collected by RRC contractor Terracon. The operators of surrounding oil and gas leases have collected gas samples from their wells to determine if oil and gas operations contributed to the flash fire which occurred on August 2, 2014, from the Murray water well. At this time, the RRC awaits complete results of the water and gas samples.

The complainant is advised that the Site Remediation Department continues to work alongside the District Office in determining whether oil and gas operations contributed to the flash fire originating from the Murray water well.

File review is scheduled for the week of February 9, 2015. **Please direct any questions with regard to this complaint to Gene Ortiz at (325)-677-3545.**

Sincerely,

A handwritten signature in black ink, appearing to read "Gene Ortiz".

Gene Ortiz  
Engineering Specialist

GO/m/m

☒ Assistant District Director  
☐ District Director

cc: Field Operations, RRC, Austin

Cody Murray  
PO Box 164  
Perrin, TX 76486

Peter Pope  
Site Remediation  
RRC - Austin

## Gene Ortiz

---

**From:** Peter Pope  
**Sent:** Monday, December 08, 2014 3:15 PM  
**To:** [REDACTED]  
**Cc:** Gene Ortiz; Madelyn Flannagan  
**Subject:** FW: Singleton Wells: Job No. 14-5522 and 14-9770  
**Attachments:** Isotopic Composition.pdf

Thank you Patty.

Peter

---

**From:** Patty Reyes [REDACTED]  
**Sent:** Monday, December 08, 2014 3:11 PM  
**To:** Peter Pope  
**Subject:** FW: Singleton Wells: Job No. 14-5522 and 14-9770

Peter

Please see the attached file for submittal to the RRC containing laboratory results for the Singleton Wells, Job No. 14-5522 and 14-9770. Please note that two cylinders sent to the Isotech Laboratory where received by this laboratory in a compromised condition, so no isotope data will be reported for those samples. The presence of oxygen, and lack of pressure at the initial GC analysis, as well as significantly lower concentrations of hydrocarbons at the second GC analysis indicate the sample containers were compromised somehow in shipment. However, the repeatability and correlative results of the other eight (8) samples validate the uniformity of the gas being produced from both the Singleton and Singleton B Unit wells.



**Patty Reyes**  
Senior Regulatory Assistant  
421 W. 3<sup>rd</sup> Street, Suite 150  
Ft. Worth, TX 76102  
Office: (817) 344-1218  
Fax: (817) 344-1219  
[REDACTED]



# ANALYSIS REPORT

Lab #: 463396 Job #: 26842 IS-74114 Co. Job#:  
Sample Name: Singleton Unit #1H Co. Lab#:  
Company: EOG Resources Cylinder: 2218  
API/Well:  
Container: 300 ml stainless  
Field/Site Name: SPLO10149A  
Location:  
Formation:  
Sampling Point:  
Date Sampled: 9/05/2014 Date Received: 10/10/2014 Date Reported: 11/17/2014

Component	Chemical mol. %	$\delta^{13}\text{C}$ ‰	$\delta\text{D}$ ‰	$\delta^{15}\text{N}$ ‰
Carbon Monoxide -----	nd			
Helium -----	0.0823			
Hydrogen -----	0.0140			
Argon -----	0.0050			
Oxygen -----	nd			
Nitrogen -----	1.51			
Carbon Dioxide -----	0.49			
Methane -----	76.78	-46.79	-207.9	
Ethane -----	12.87	-37.91		
Ethylene -----	nd			
Propane -----	5.18	-33.09		
Propylene -----	nd			
Iso-butane -----	0.522			
N-butane -----	1.38			
Iso-pentane -----	0.291			
N-pentane -----	0.364			
Hexanes + -----	0.511			

Total BTU/cu.ft. dry @ 60deg F & 14.73psia, calculated: 1253

Specific gravity, calculated: 0.730

nd = not detected. na = not analyzed. Isotopic composition of hydrogen is relative to VSMOW. Isotopic composition of carbon is relative to VPDB. Calculations for BTU and specific gravity per ASTM D3588. Chemical compositions are normalized to 100%. Mol. % is approximately equal to vol. %.





# ANALYSIS REPORT

Lab #: 463397 Job #: 26842 IS-74114 Co. Job#:  
Sample Name: Singleton Unit #4H Co. Lab#:  
Company: EOG Resources Cylinder: 7189  
API/Well:  
Container: 300 ml stainless  
Field/Site Name: SPLO10149A  
Location:  
Formation:  
Sampling Point:  
Date Sampled: 9/05/2014 Date Received: 10/10/2014 Date Reported: 11/17/2014

Component	Chemical mol. %	$\delta^{13}\text{C}$ ‰	$\delta\text{D}$ ‰	$\delta^{15}\text{N}$ ‰
Carbon Monoxide -----	nd			
Helium -----	0.0872			
Hydrogen -----	0.0358			
Argon -----	0.0054			
Oxygen -----	nd			
Nitrogen -----	1.55			
Carbon Dioxide -----	0.54			
Methane -----	76.83	-46.69	-207.0	
Ethane -----	12.71	-37.93		
Ethylene -----	nd			
Propane -----	5.12	-33.16		
Propylene -----	nd			
Iso-butane -----	0.516			
N-butane -----	1.37			
Iso-pentane -----	0.294			
N-pentane -----	0.370			
Hexanes + -----	0.573			

Total BTU/cu.ft. dry @ 60deg F & 14.73psia, calculated: 1252

Specific gravity, calculated: 0.730

nd = not detected. na = not analyzed. Isotopic composition of hydrogen is relative to VSMOW. Isotopic composition of carbon is relative to VPDB. Calculations for BTU and specific gravity per ASTM D3588. Chemical compositions are normalized to 100%. Mol. % is approximately equal to vol. %.



## ANALYSIS REPORT

Lab #: 463398 Job #: 26842 IS-74114 Co. Job#:  
Sample Name: Singleton Unit #3H Co. Lab#:  
Company: EOG Resources Cylinder: 0550  
API/Well:  
Container: 300 ml stainless  
Field/Site Name: SPLO10149A  
Location:  
Formation:  
Sampling Point:  
Date Sampled: 9/05/2014 Date Received: 10/10/2014 Date Reported: 11/17/2014

Component	Chemical mol. %	$\delta^{13}\text{C}$ ‰	$\delta\text{D}$ ‰	$\delta^{15}\text{N}$ ‰
Carbon Monoxide -----	nd			
Helium -----	0.0787			
Hydrogen -----	0.0786			
Argon -----	0.0144			
Oxygen -----	0.16			
Nitrogen -----	2.54			
Carbon Dioxide -----	0.59			
Methane -----	75.89	-44.51	-202.5	
Ethane -----	12.48	-37.51		
Ethylene -----	nd			
Propane -----	5.05	-33.21		
Propylene -----	nd			
Iso-butane -----	0.510			
N-butane -----	1.37			
Iso-pentane -----	0.296			
N-pentane -----	0.376			
Hexanes + -----	0.562			

Total BTU/cu.ft. dry @ 60deg F & 14.73psia, calculated: 1236

Specific gravity, calculated: 0.734

nd = not detected. na = not analyzed. Isotopic composition of hydrogen is relative to VSMOW. Isotopic composition of carbon is relative to VPDB. Calculations for BTU and specific gravity per ASTM D3588. Chemical compositions are normalized to 100%. Mol. % is approximately equal to vol. %.



# ANALYSIS REPORT

Lab #: 463399 Job #: 26842 IS-74114 Co. Job#:  
Sample Name: Singleton B Unit #2H Co. Lab#:  
Company: EOG Resources Cylinder: 1945  
API/Well:  
Container: 300 ml stainless  
Field/Site Name: SPLO10149A  
Location:  
Formation:  
Sampling Point:  
Date Sampled: 9/05/2014 Date Received: 10/10/2014 Date Reported: 11/17/2014

Component	Chemical mol. %	$\delta^{13}\text{C}$ ‰	$\delta\text{D}$ ‰	$\delta^{15}\text{N}$ ‰
Carbon Monoxide -----	nd			
Helium -----	0.0896			
Hydrogen -----	0.0252			
Argon -----	0.0086			
Oxygen -----	0.036			
Nitrogen -----	1.94			
Carbon Dioxide -----	0.50			
Methane -----	77.08	-46.86	-207.0	
Ethane -----	12.45	-38.39		
Ethylene -----	nd			
Propane -----	4.95	-33.83		
Propylene -----	nd			
Iso-butane -----	0.493			
N-butane -----	1.32			
Iso-pentane -----	0.281			
N-pentane -----	0.354			
Hexanes + -----	0.468			

Total BTU/cu.ft. dry @ 60deg F & 14.73psia, calculated: 1237

Specific gravity, calculated: 0.725

nd = not detected. na = not analyzed. Isotopic composition of hydrogen is relative to VSMOW. Isotopic composition of carbon is relative to VPDB. Calculations for BTU and specific gravity per ASTM D3588. Chemical compositions are normalized to 100%. Mol. % is approximately equal to vol. %.

# ANALYSIS REPORT

Lab #: 463400      Job #: 26842      IS-74114      Co. Job#: \_\_\_\_\_  
 Sample Name: Singleton B Unit #1H      Co. Lab#: \_\_\_\_\_  
 Company: EOG Resources      Cylinder: 1957  
 API/Well: \_\_\_\_\_  
 Container: 300 ml stainless  
 Field/Site Name: SPLO10149A  
 Location: \_\_\_\_\_  
 Formation: \_\_\_\_\_  
 Sampling Point: \_\_\_\_\_  
 Date Sampled: 9/05/2014      Date Received: 10/10/2014      Date Reported: 11/17/2014

Component	Chemical mol. %	$\delta^{13}\text{C}$ ‰	$\delta\text{D}$ ‰	$\delta^{15}\text{N}$ ‰
Carbon Monoxide -----	nd			
Helium -----	0.0921			
Hydrogen -----	0.119			
Argon -----	0.0060			
Oxygen -----	nd			
Nitrogen -----	1.65			
Carbon Dioxide -----	0.50			
Methane -----	77.22	-46.86	-205.5	
Ethane -----	12.41	-38.36		
Ethylene -----	nd			
Propane -----	4.98	-33.66		
Propylene -----	nd			
Iso-butane -----	0.500			
N-butane -----	1.34			
Iso-pentane -----	0.289			
N-pentane -----	0.366			
Hexanes + -----	0.529			

Total BTU/cu.ft. dry @ 60deg F & 14.73psia, calculated: 1243

Specific gravity, calculated: 0.725

nd = not detected. na = not analyzed. Isotopic composition of hydrogen is relative to VSMOW. Isotopic composition of carbon is relative to VPDB. Calculations for BTU and specific gravity per ASTM D3588. Chemical compositions are normalized to 100%. Mol. % is approximately equal to vol. %.



# ANALYSIS REPORT

Lab #: 463403 Job #: 26842 IS-74114 Co. Job#:  
Sample Name: Singleton B Unit #5H Co. Lab#:  
Company: EOG Resources Cylinder: 7369  
API/Well:  
Container: 300 ml stainless  
Field/Site Name: SPLO10149A  
Location:  
Formation:  
Sampling Point:  
Date Sampled: 9/05/2014 Date Received: 10/10/2014 Date Reported: 11/17/2014

Component	Chemical mol. %	$\delta^{13}\text{C}$ ‰	$\delta\text{D}$ ‰	$\delta^{15}\text{N}$ ‰
Carbon Monoxide -----	nd			
Helium -----	0.0881			
Hydrogen -----	0.0108			
Argon -----	0.0057			
Oxygen -----	0.029			
Nitrogen -----	1.56			
Carbon Dioxide -----	0.57			
Methane -----	76.43	-46.94	-202.2	
Ethane -----	12.80	-38.70		
Ethylene -----	nd			
Propane -----	5.23	-34.06		
Propylene -----	nd			
Iso-butane -----	0.524			
N-butane -----	1.45			
Iso-pentane -----	0.311			
N-pentane -----	0.403			
Hexanes + -----	0.586			

Total BTU/cu.ft. dry @ 60deg F & 14.73psia, calculated: 1258

Specific gravity, calculated: 0.735

nd = not detected. na = not analyzed. Isotopic composition of hydrogen is relative to VSMOW. Isotopic composition of carbon is relative to VPDB. Calculations for BTU and specific gravity per ASTM D3588. Chemical compositions are normalized to 100%. Mol. % is approximately equal to vol. %.



# ANALYSIS REPORT

Lab #: 463404 Job #: 26842 IS-74114 Co. Job#:  
Sample Name: Singleton B Unit #4H Co. Lab#:  
Company: EOG Resources Cylinder: 8383  
API/Well:  
Container: 300 ml stainless  
Field/Site Name: SPLO10149A  
Location:  
Formation:  
Sampling Point:  
Date Sampled: 9/05/2014 Date Received: 10/10/2014 Date Reported: 11/17/2014

Component	Chemical mol. %	$\delta^{13}\text{C}$ ‰	$\delta\text{D}$ ‰	$\delta^{15}\text{N}$ ‰
Carbon Monoxide -----	nd			
Helium -----	0.0792			
Hydrogen -----	nd			
Argon -----	0.0087			
Oxygen -----	0.10			
Nitrogen -----	2.03			
Carbon Dioxide -----	0.52			
Methane -----	75.78	-45.58	-204.9	
Ethane -----	12.81	-37.79		
Ethylene -----	nd			
Propane -----	5.30	-33.18		
Propylene -----	nd			
Iso-butane -----	0.544			
N-butane -----	1.47			
Iso-pentane -----	0.321			
N-pentane -----	0.405			
Hexanes + -----	0.635			

Total BTU/cu.ft. dry @ 60deg F & 14.73psia, calculated: 1257

Specific gravity, calculated: 0.740

nd = not detected. na = not analyzed. Isotopic composition of hydrogen is relative to VSMOW. Isotopic composition of carbon is relative to VPDB. Calculations for BTU and specific gravity per ASTM D3588. Chemical compositions are normalized to 100%. Mol. % is approximately equal to vol. %.

# ANALYSIS REPORT

Lab #: 463405      Job #: 26842      IS-74114      Co. Job#: \_\_\_\_\_  
 Sample Name: Singleton B Unit #3RH      Co. Lab#: \_\_\_\_\_  
 Company: EOG Resources      Cylinder: 1240  
 API/Well: \_\_\_\_\_  
 Container: 300 ml stainless  
 Field/Site Name: SPLO10149A  
 Location: \_\_\_\_\_  
 Formation: \_\_\_\_\_  
 Sampling Point: \_\_\_\_\_  
 Date Sampled: 9/05/2014      Date Received: 10/10/2014      Date Reported: 11/17/2014

Component	Chemical mol. %	$\delta^{13}\text{C}$ ‰	$\delta\text{D}$ ‰	$\delta^{15}\text{N}$ ‰
Carbon Monoxide -----	nd			
Helium -----	0.0859			
Hydrogen -----	0.0238			
Argon -----	0.0171			
Oxygen -----	0.24			
Nitrogen -----	2.81			
Carbon Dioxide -----	0.53			
Methane -----	76.06	-45.89	-202.7	
Ethane -----	12.37	-38.04		
Ethylene -----	nd			
Propane -----	4.92	-33.60		
Propylene -----	nd			
Iso-butane -----	0.492			
N-butane -----	1.31			
Iso-pentane -----	0.280			
N-pentane -----	0.357			
Hexanes + -----	0.504			

Total BTU/cu.ft. dry @ 60deg F & 14.73psia, calculated: 1226

Specific gravity, calculated: 0.730

nd = not detected. na = not analyzed. Isotopic composition of hydrogen is relative to VSMOW. Isotopic composition of carbon is relative to VPDB. Calculations for BTU and specific gravity per ASTM D3588. Chemical compositions are normalized to 100%. Mol. % is approximately equal to vol. %.





## RAILROAD COMMISSION OF TEXAS

### OIL AND GAS DIVISION

October 20, 2014

Mr. Cody Murray  
P.O. Box 164  
Perrin, Palo Pinto County, TX 76486

Re: August 2014 Water Well Sampling

Dear Mr. Murray:

Please find enclosed a copy of the Water Well Sampling Report from the August 21, 2014 sampling event. Water samples and dissolved gas in water samples were collected from your water well by Terracon Consultants, Inc., under contract with the Railroad Commission of Texas (RRC).

The samples were analyzed for the following constituents commonly associated with oil and gas activities: benzene, toluene, ethylbenzene, and total xylenes (BTEX), total petroleum hydrocarbons (TPH), chloride, hydrogen sulfide, dissolved gases, and general water chemistry parameters. Laboratory samples were analyzed by TestAmerica Laboratories, Inc and ISOTECH Laboratories, Inc.

The analytical results indicate that the dissolved methane gas concentration was 14 milligrams per liter (mg/l), exceeding the U.S. Department of the Interior's recommended action level of 10 mg/l. Methane dissolved in groundwater is not explosive; however, when water containing dissolved methane comes into contact with air, this condition could present a potential explosion hazard, especially if it occurs in a confined space such as a well pump house. You may also consider installing a well water aeration system to further remove dissolved methane from your well water.

All other constituents were either not detected, or detected below national primary and secondary drinking water standards, U.S. Department of the Interior, Office of Surface Mining, action levels, or Texas Commission on Environmental Quality (TCEQ) Texas Risk Reduction Program (TRRP) Rule Tier 1 residential groundwater ingestion protective concentration levels (PCLs), where regulatory guidance is provided.

The RRC's investigation into possible sources of methane in your groundwater is ongoing.

If you have questions about this report, please contact the RRC toxicologist Amanda Kindt at (512) 475-3089 or by email at [amanda.kindt@rrc.state.tx.us](mailto:amanda.kindt@rrc.state.tx.us).

10/20/2014

Page 2 of 2

Sincerely,

A handwritten signature in dark ink, appearing to read "Peter G. Pope", with a long horizontal flourish extending to the right.

Peter G. Pope, Assistant Director  
Site Remediation Section

Enclosure

cc: Gene Ortiz, RRC District 7B Office, Abilene

CHRISTI CRADDICK, CHAIRMAN  
DAVID PORTER, COMMISSIONER  
BARRY T. SMITHERMAN, COMMISSIONER



GIL BUJANO, P.E.  
DIRECTOR, OIL AND GAS DIVISION  
D. W. -JOE- CRESS  
DISTRICT DIRECTOR

# RAILROAD COMMISSION OF TEXAS

## OIL AND GAS DIVISION

October 14, 2014

Unidentified Operator

### STATUS REPORT

#### **Murray, Cody Complaint No. 7B-10736**

Murray Property  
Murray Water Well  
Palo Pinto County, Texas  
Job No. 14-9803

Cody Murray's initial concern was a flash fire originating from his water well possibly caused by oil and gas activities. File review conducted on October 13, 2014, by Gene Ortiz revealed the following:

On August 21, 2014, water samples from the Murray water well were collected by RRC contractor Terracon. The operators of surrounding oil and gas leases have collected gas samples from their wells to determine if oil and gas operations contributed to the flash fire which occurred on August 2, 2014, from the Murray water well. At this time, the RRC awaits complete results of the water and gas samples.

The complainant is advised that the Site Remediation Department continues to work alongside the District Office in determining whether oil and gas operations contributed to the flash fire originating from the Murray water well.

File review is scheduled for the week of November 28, 2014. **Please direct any questions with regard to this complaint to Gene Ortiz at (325)-677-3545.**

Sincerely,

A handwritten signature in black ink, appearing to read "Gene Ortiz".

Gene Ortiz  
Engineering Specialist

GO/mm

☒ Assistant District Director

☐ District Director

cc: Field Operations, RRC, Austin

Cody Murray  
PO Box 164  
Perrin, TX 76486

Peter Pope  
Site Remediation  
RRC - Austin



STANDLY | HAMILTON, LLP

RECEIVED  
RRC OF TEXAS  
SEP 25 2014  
O&G  
ABILENE, TX**Fax Cover Sheet****September 25, 2014**

TO	COMPANY	FAX NUMBER:
Oil and Gas Division	RAILROAD COMMISSION OF TEXAS	(325) 677 7122

**FROM: Christopher S. Hamilton****Fax Number: (214) 234-7300**

Regarding:	Initial Report; Cody Murray Complaint No. 7B 10736	
Number of Pages, including fax cover sheet	2	
Message:	See attached.	

**CONFIDENTIALITY NOTICE**

The information contained in this facsimile transmission is confidential. It may also be subject to the attorney-client privilege, work product, or proprietary information. This information is intended for the exclusive use of the addressee named above. If you are not the intended recipient, you are hereby notified that any use, disclosure, dissemination, distribution (other than to the addressee named above), copying, or the taking of any action because of this information is strictly prohibited. If you have received this communication in error, please immediately notify us by telephone to arrange for return of the documents.



STANDLY | HAMILTON, LLP

September 25, 2014

Via Facsimile (325) 677-7122

Railroad Commission of Texas  
Oil and Gas Division  
3444 North First, Suite 600  
Abilene, Texas 79603

RECEIVED  
RRC OF TEXAS  
SEP 25 2014  
O&G  
ABILENE, TX

**Re: Initial Report; Cody Murray Complaint No. 7B-10736**

To Whom It May Concern:

Our firm represents the Murray family relating to the incident on August 2, 2014. We received the Initial Report from the Railroad Commission of Texas, dated August 18, 2014, and would like to clarify a few items in the report. First, Cody Murray was informed of the water bubbling out of the water well by his wife Ashley, not his daughter Alyssa. Second, Cody and Alyssa were not taken to area hospitals with injuries; instead, they were life-flighted to Parkland Hospital in Dallas, Texas. Third, while Cody's brother-in-law, George Hodges, may not have been aware of any water issues the Murrys had prior to the flash fire, the Murrys had experienced significant problems with their water leading up to this incident.

I appreciate your assistance in this matter. Please do not hesitate to call if there are any questions. Thank you.

Sincerely,

Christopher Hamilton

Phone: (214) 234-7900

## RAILROAD COMMISSION OF TEXAS

Oil & Gas Division  
Compliance SectionDistrict Office  
INSPECTION REPORTD-O  
rev. 6/07JOB NO. **14-9803 -04**  
DISTRICT **7B**

OPERATOR **UNIDENTIFIED**  
 LEASE/FACILITY **MURRAY PROPERTY**  
 WELL No.(s) \_\_\_\_\_  
 FIELD \_\_\_\_\_  
 COUNTY **PALO PINTO** ☐ COSTAL MGT AREA  
☐ COMPLAINT NO. **7B-10736**  
 COMPLAINANT NAME **CODY MURRAY**  
 DIRECTIONS \_\_\_\_\_

LEASE/ID \_\_\_\_\_  
 DRILL PMT. NO. \_\_\_\_\_  
 PLANT NO. \_\_\_\_\_  
 PIT PMT. NO. \_\_\_\_\_  
 PIPELINE PMT NO. \_\_\_\_\_  
 OTHER \_\_\_\_\_  
 LE DOCKET \_\_\_\_\_  
 SFP CODE \_\_\_\_\_  
 SFCU CODE \_\_\_\_\_

☐ MUST WITNESS  
☐ Field Initiated  
☐ Taken By \_\_\_\_\_  
☐ District ☐ Austin  
☐ Backcheck  
☒ Co-inspection  
☐ Sweep  
 TOTAL:  
 UIC WELLS INSP \_\_\_\_\_  
 WELLS INSP \_\_\_\_\_  
 SITES INSP **1**

% TIME	UIC	ENV	SITE REM
LEGAL ENF	PRO/PROD	TERRA	
SFP	OTHER		

GPS COORDINATES: ☒ NO ☐ YES LOG# \_\_\_\_\_  
 LAT \_\_\_\_\_ LONG \_\_\_\_\_

ACTIVITY (check appropriate boxes)

<input type="checkbox"/> BLOWOUT	<input type="checkbox"/> OIL SPILL (NON SEN)
<input type="checkbox"/> COM. SURFACE DISP. FAC.	<input type="checkbox"/> OIL SPILL (SENS)
<input type="checkbox"/> COM. DISPOSAL WELL	<input type="checkbox"/> PIT INSPECTION
<input type="checkbox"/> FLARE/VENT	<input type="checkbox"/> PLANT INSP
<input type="checkbox"/> DISPOSAL/INJECTION	<input type="checkbox"/> PLUGGING (OPER)
<input type="checkbox"/> DRILLING RIG	<input type="checkbox"/> PLUGGING (SFP)
<input type="checkbox"/> FIRE	<input type="checkbox"/> PROD WATER SPILL
<input type="checkbox"/> H2S COMPLIANCE INSP.	<input type="checkbox"/> PROD TEST
<input type="checkbox"/> H2S INCIDENT	<input type="checkbox"/> PROD/INT CASING
<input type="checkbox"/> HYDROCARBON STRING	<input type="checkbox"/> SEAL WELL
<input checked="" type="checkbox"/> LEASE INSPECTION	<input type="checkbox"/> SITE ASSMT (SFCU)
<input type="checkbox"/> MIT	<input type="checkbox"/> SITE CLEAN UP SFCU
<input type="checkbox"/> MINOR PERMIT	<input type="checkbox"/> SURFACE CASING
<input type="checkbox"/> OFFICE	<input type="checkbox"/> WASTE HAULER
<input type="checkbox"/> OTHER	

Comments: \_\_\_\_\_

## FIELD INSPECTION STATUS

		COMPLIANCE		Prev viols	New viols	Total viols
		yes	no			
SWR 2	Access to Property	<input type="checkbox"/>	<input type="checkbox"/>			
SWR 3	Signs	<input type="checkbox"/>	<input type="checkbox"/>			
SWR 8	Water Protection	<input type="checkbox"/>	<input type="checkbox"/>			
SWR 9	Disposal Wells	<input type="checkbox"/>	<input type="checkbox"/>			
SWR 13	Casing/Cementing	<input type="checkbox"/>	<input type="checkbox"/>			
SWR 14(B)(2)	Inactive wells	<input type="checkbox"/>	<input type="checkbox"/>			
SWR 17	Pressure on Bradenhead	<input type="checkbox"/>	<input type="checkbox"/>			
SWR 21	Firewalls	<input type="checkbox"/>	<input type="checkbox"/>			
SWR 22	Protection of Birds	<input type="checkbox"/>	<input type="checkbox"/>			
SWR 27	Gas Metering	<input type="checkbox"/>	<input type="checkbox"/>			
SWR 32	Flaring/Venting	<input type="checkbox"/>	<input type="checkbox"/>			
SWR 36	Hydrogen Sulfide	<input type="checkbox"/>	<input type="checkbox"/>			
SWR 46	Injection Wells	<input type="checkbox"/>	<input type="checkbox"/>			
SWR 91	Oil Spill Clean-up	<input type="checkbox"/>	<input type="checkbox"/>			
OTHER		<input type="checkbox"/>	<input type="checkbox"/>			
OTHER		<input type="checkbox"/>	<input type="checkbox"/>			

SEE DA

CO-INSPECTION WITH TRISH HUDSON, SEE HER REPORT FOR ADDITIONAL INFORMATION

RRC PERSONEL ON LOCATION DEBBIE GARCIA AND SHANNA SMITH

I CERTIFY THIS DATA IS TRUE AND COMPLETE:

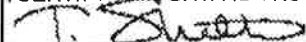
TECH NO. **410** DATE **8/21/2014**

START:

MILEAGE

**130440**

TIME

**1115**

LUNCH

**60** (MIN)

END:

**130570****1930**☐ Job Interrupt

OFFICE REVIEW

BY \_\_\_\_\_

DATE \_\_\_\_\_



JOB NO. 14-9803

DISTRICT 7B

OPERATOR UNIDENTIFIED

LEASE/FACILITY#

LEASE/FACILITY MURRAY PROPERTY

COUNTY PALO PINTO

COMPLAINT NAME CODY MURRAY

COMPLAINT NO. 7B-10736

TRISH HUDSON, SHANNA SMITH, DEBBIE GARCIA AND I ARRIVED ON MURRAY PROPERTY  
AT APPROXIMATELY 1120

ON SITE RIGHT AHEAD OF OUR ARRIVAL IS:

PAUL ROSENFELD

ROB HESSE

ANDERS SUTHERLAND

SWAPE REPS

ANGELA PACHECO

STANDLY & HAMILTON REP

MAX MAJESKO AND WADE WATKINS, TERRACON REPS, ARRIVED ON LOCATION WITH US

1130

BURKE LYONS, ERWIN WATER WELL DRILLING ARRIVED ON LOCATION. HE STATED THERE IS  
A SERVICE TRUCK ENROUTE AND HE WILL NEED TO GO UP TO THE INTERSECTION TO BRING  
IN. MR. LYONS LEFT THE PROPERTY

1145

MR. LYONS RETURNED TO LOCATION WITH A SERVICE TRUCK WITH A 2 MAN CREW

THE CREW IS:

ISRAEL

ANTONIO

ROB HESSE STATED 20PPM OF METHANE, HE IS USING A CGI METER

MR. LYONS STATED THE FOLLOWING:

WELL DRILLED 10-12-1999 FOR PREVIOUS LANDOWNER AUDIE RANY

DRILLED TO TOTAL DEPTH 220'

155' - 198' LIMESTONE SOLID

202' - 206' LIMESTONE FRACTURED

206' -220' GRAY SHALE

SLOTTED PVC 20' FROM 160' - 180'

SLOTTED PVC 20' FROM 200' - 220'

YEILD 50 GALLONS PER MINUTE

I CERTIFY THIS DATA IS TRUE AND COMPLETE:



TECH NO. 410

DATE 08/21/14

Page 2 of 3

OFFICE REVIEW

BY

DATE



JOB NO. 14-9803

DISTRICT 7B

OPERATOR UNIDENTIFIED

LEASE/FACILITY#

LEASE/FACILITY MURRAY PROPERTY

COUNTY PALO PINTO

COMPLAINT NAME CODY MURRAY

COMPLAINT NO. 7B-10736

STATIC WATER AT 120'

1 HORSE POWER PUMP THAT IS CAPABLE OF PUMPING 18 GALLONS PER MINUTE

HE DRILLED THE WATER WELL LOCATED ON THE PROPERTY TO WEST, DRILLED IT 220', DID NOT ENCOUNTER THE FRACTURED LIMESTONE AND THAT WELL'S YEILD IS 4 1/2 TO 5 GALLONS PER MINUTE.

HE DID NOT DRILL THE SINGLETON WELL, BUT HAS DONE SERVICE WORK FOR RICHARD AND THE WELL IS WEAK, YIELD IS ONLY 2 1/2 GALLONS PER MINUTE

HE OFFERED TO EMAIL LOGS ON THE MURRAY WATER WELL AND THE WATER TO THE WEST OF MURRAY PROPERTY.

VERIFIED WITH TRISH THAT MR. LYONS COULD EMAIL THE INFORMATION REGARDING THE 2 WATER WELLS, GAVE MR. LYONS TRISH'S CARD WATER WELL

SERVICE TRUCK WAS STAGED TO THE EAST OF THE WATER WELL HOUSE

THEY RAN ELECTRICAL LINE TO THE WELL HEAD, CONNECTED TO PROVIDE ELECTRICITY TO THE DOWN HOLE PUMP. THEY STAGED THE GENERATOR UP WIND AND TO THE EAST OF WELL HOUSE

DR. ROSENFELD STATED METHANE LEL IS 30% FROM WELL BORE

MR. HESSE AND TERRACON REPS DISCUSSED WITH ISREAL WHAT THEY WILL NEED TO ENABLE BOTH PARTIES TO PULL SAMPLES. ISRAEL AND ANTONIO ATTACHED PVC TO THE WELL HEAD, RAN THE PIPING OUT OF THE WELL HOUSE TO THE EAST, ATTACHED A 90 DEGREE ELBOW, ANOTHER JOINT OF PVC AND RAN IT TO THE NORTH. ATTACHED A TEE, ON THE WEST SIDE OF TEE ATTACHED A SPIGOT AND THE EAST SIDE AN PVC EXTENTION AND A VALVE

ISRAEL STARTED GENERATOR AND WATER STARTED FLOWING

SEE TRISH HUDSON'S REPORT REGARDING THE SAMPLING OF WATER

THRU OUT THE COLLECTION OF SAMPLES AND THE FLOW OF WATER, SWAPE GROUP CONSTANTLY MONITORED THE LEL OF THE WELL HOUSE & THE FLOWING WATER AND THE LEL IS ZERO.

UPON COMPLETION OF SWAPE AND TERRACON COLLECTING OF SAMPLES. DR. ROSENFELD STATED THE LEL IS ZERO.

I CERTIFY THIS DATA IS TRUE AND COMPLETE:



TECH NO. 410

DATE 08/21/14

Page 3 of 3

OFFICE REVIEW

BY

DATE

## RAILROAD COMMISSION OF TEXAS

Oil and Gas Division  
Compliance SectionDistrict Office  
INSPECTION REPORTD-O  
rev. 6/07JOB NO. 14-9803-03  
DISTRICT 7BOPERATOR **MURRAY PROPERTY**  
LEASE/FACILITY **MURRAY WATER WELL**  
WELL No.(s) \_\_\_\_\_  
FIELD \_\_\_\_\_  
COUNTY **PALO PINTO** ☐ COSTAL MGT AREA  
☒ COMPLAINT NO. **7B-10736**  
COMPLAINANT NAME **CODY MURRAY**  
DIRECTIONS \_\_\_\_\_  
\_\_\_\_\_  
\_\_\_\_\_  
\_\_\_\_\_LEASE/ID \_\_\_\_\_  
DRILL PMT. NO. \_\_\_\_\_  
PLANT NO. \_\_\_\_\_  
PIT PMT. NO. \_\_\_\_\_  
PIPELINE PMT NO. \_\_\_\_\_  
OTHER \_\_\_\_\_  
LE DOCKET \_\_\_\_\_  
SFP CODE \_\_\_\_\_  
SFCU CODE \_\_\_\_\_☐ MUST WITNESS  
☐ Field Initiated  
☐ Taken By \_\_\_\_\_  
☐ District ☐ Austin  
☒ Backcheck  
☒ Co-inspection  
☐ Sweep  
TOTAL:  
UIC WELLS INSP \_\_\_\_\_  
WELLS INSP **1**  
SITES INSP \_\_\_\_\_

% TIME	UIC	ENV	SITE REM
LEGAL ENF		PRO/PROD	TERRA
SFP		OTHER	

GPS COORDINATES: ☒ NO ☐ YES LOG# \_\_\_\_\_

LAT \_\_\_\_\_ LONG \_\_\_\_\_

ACTIVITY (check appropriate boxes)			
A <input type="checkbox"/> BLOWOUT	P <input type="checkbox"/> OIL SPILL (NON SEN)		
B <input type="checkbox"/> COM. SURFACE DISP. FAC.	Q <input type="checkbox"/> OIL SPILL (SENS)		
C <input type="checkbox"/> COM. DISPOSAL WELL	R <input type="checkbox"/> PIT INSPECTION		
D <input type="checkbox"/> FLARE/VENT	S <input type="checkbox"/> PLANT INSP		
E <input type="checkbox"/> DISPOSAL/INJECTION	T <input type="checkbox"/> PLUGGING (OPER)		
F <input type="checkbox"/> DRILLING RIG	U <input type="checkbox"/> PLUGGING (SFP)		
G <input type="checkbox"/> FIRE	V <input type="checkbox"/> PROD WATER SPILL		
H <input type="checkbox"/> H2S COMPLIANCE INSP.	W <input type="checkbox"/> PROD TEST		
I <input type="checkbox"/> H2S INCIDENT	X <input type="checkbox"/> PROD/INT CASING		
J <input type="checkbox"/> HYDROCARBON STRING	Y <input type="checkbox"/> SEAL WELL		
K <input checked="" type="checkbox"/> LEASE INSPECTION	Z <input type="checkbox"/> SITE ASSMT (SFCU)		
L <input type="checkbox"/> MIT	AA <input type="checkbox"/> SITE CLEAN UP SFCU		
M <input type="checkbox"/> MINOR PERMIT	BB <input type="checkbox"/> SURFACE CASING		
N <input type="checkbox"/> OFFICE	CC <input type="checkbox"/> WASTE HAULER		
O <input type="checkbox"/> OTHER			

FIELD INSPECTION STATUS		COMPLIANCE		Prev	New	Total
		yes	no	viols.	viols.	viols.
SWR 2	Access to Property	<input type="checkbox"/>	<input type="checkbox"/>			
SWR 3	Signs	<input type="checkbox"/>	<input type="checkbox"/>			
SWR 8	Water Protection	<input type="checkbox"/>	<input type="checkbox"/>			
SWR 9	Disposal Wells	<input type="checkbox"/>	<input type="checkbox"/>			
SWR 13	Casing/Cementing	<input type="checkbox"/>	<input type="checkbox"/>			
SWR 14(B)(2)	Inactive wells	<input type="checkbox"/>	<input type="checkbox"/>			
SWR 17	Pressure on Bradenhead	<input type="checkbox"/>	<input type="checkbox"/>			
SWR 21	Firewalls	<input type="checkbox"/>	<input type="checkbox"/>			
SWR 22	Protection of Birds	<input type="checkbox"/>	<input type="checkbox"/>			
SWR 27	Gas Metering	<input type="checkbox"/>	<input type="checkbox"/>			
SWR 32	Flaring/Venting	<input type="checkbox"/>	<input type="checkbox"/>			
SWR 36	Hydrogen Sulfide	<input type="checkbox"/>	<input type="checkbox"/>			
SWR 46	Injection Wells	<input type="checkbox"/>	<input type="checkbox"/>			
SWR 91	Oil Spill Clean-up	<input type="checkbox"/>	<input type="checkbox"/>			
OTHER		<input type="checkbox"/>	<input type="checkbox"/>			
OTHER		<input type="checkbox"/>	<input type="checkbox"/>			

Comments: \_\_\_\_\_

**JOINT INSPECTION WITH TAMMY SHELTON, SHANNA SMITH, AND TRISH HUDSON (LEAD INSPECTOR)**  
**ALSO PRESENT AT THIS LOCATION WAS TERRACON (2 REPRESENTATIVES), MR MURRAY'S LAW FIRM**  
**REPRESENTATIVE, DR ROSENTHAL AND HIS TEAM (3 REPRESENTATIVES IN TOTAL) AND WATER WELL**  
**SERVICING COMPANY (3 REPRESENTATIVES)**

**WATER WELL SERVICING COMPANY ASSISTED IN GAINING ACCESS TO WATER WELL BY CONNECTING**  
**NEW PVC TO WELLHEAD AND THEN BY POWERING WELL WITH A GENERATOR, WATER WAS BROUGHT UP**  
**FROM THE WELLBORE.**  
**(CONT. ON NEXT PAGE)**

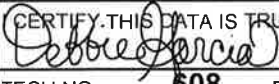
CERTIFY THIS DATA IS TRUE AND COMPLETE: 		MILEAGE <b>96,344</b>	TIME <b>1130</b>	LUNCH <b>60</b> (MIN)
TECH NO. <b>608</b>	DATE <b>08/21/14</b>	START: <b>96,390</b>	END: <b>1645</b>	<input type="checkbox"/> Job Interrupt

OFFICE REVIEW BY _____ DATE _____
---

RAILROAD COMMISSION OF TEXAS  
Oil and Gas Division  
Compliance Section

District Office  
INSPECTION REPORT  
ATTACHMENT SHEET

D-A  
rev. 5/06

JOB NO. 14-9803

DISTRICT 7B

OPERATOR MURRAY PROPERTY

LEASE/FACILITY# \_\_\_\_\_

LEASE/FACILITY MURRAY WATER WELL

COUNTY PALO PINTO

COMPLAINT NAME CODY MURRAY

COMPLAINT NO. 7B-10736

NOTED IN CONNECTION OF NEW PVC PIPING, GLUE WAS USED TO ATTACH SEGMENTS OF PVC TOGETHER AS WELL AS A FLOW CONTROL VALVE AND SPIGOT. TERRACON AND DR ROSENTHAL'S GROUP ADVISED WELL SERVICING GROUP ON ASSEMBLY NEEDED FOR SAMPLING.

WATER WELL SERVICING GROUP WAS ORIGINAL WATER WELL DRILLERS AND STATED THAT WELL WAS DRILLED FOR A AUDIE RAMEY AND WELL LOG WOULD BE UNDER THAT NAME. ALSO WATER WELL SERVICING GROUP EMAILED TRISH HUDSON AND TERRACON THE WELL LOG PAPERWORK.

PRIOR TO BEGINNING INITIAL WATER WELL PUMP OFF DR ROSENTHAL RAN A 4 GAS LEL TEST IN WELL HOUSE. A 30% LEL (LOWER EXPLOSIVE LIMIT) WAS PRESENT IN WELLHOUSE BUT RAPIDLY BEGAN TO DROP ACCORDING TO DR ROSENTHAL. DR ROSENTHAL STATED THERE WAS DEFINITE 'METHANE' IN WELL HOUSE SEVERAL TIMES TO ENTIRE GROUP PRESENT. WHEN I ASKED ONE OF DR ROSENTHAL'S ASSISTANTS LATER IF A GAS COMPOSITION IS GIVEN IN THE FOUR GAS METER USED, HE STATED NO JUST A OXYGEN (O2) AND CARBON DIOXIDE (CO2) AND TWO OTHER GASES ARE USED AS MARKERS FOR AN LEL READING. WHEN WELL WAS BEGAN TO BE PUMPED OFF, TERRACON MEASURED RATE OF FLOW WHICH WAS A 17GAL/MIN.

DURING ENTIRE SAMPLE COLLECTION OF TERRACON AND DR ROSENTHAL'S GROUP, DR ROSENTHAL'S ASSISTANTS WOULD WALK WITH 4 GAS METER AROUND WELLHOUSE, IN WELLHOUSE AND NEAR SPIGOT OF RUNNING WATER FOR DETECTION OF LEL LEVELS. NOT ONCE SINCE INITIAL READING OF 30 % LEL IN WELL HOUSE, DID 4 GAS METER ALARM.

CERTIFY THIS DATA IS TRUE AND COMPLETE:

TECH NO.

608

DATE

8/21/2014

Page

2

of

2

OFFICE REVIEW

BY \_\_\_\_\_

DATE \_\_\_\_\_

## Gene Ortiz

---

**From:** Peter Pope  
**Sent:** Friday, August 15, 2014 1:32 PM  
**To:** Gene Ortiz; Trish Hudson; Crystal Denson; Madelyn Flannagan; Michael Leckie; Art Correa  
**Cc:** Joe Cress; Darlene Wilson  
**Subject:** RE: Flash Fire 7B-10736

Hi all. Colin Lineberry and I called Mr. Hamilton this morning. I just learned that the Murray's will get their water well running next Thursday, and Dr. Paul Rosenthal will sample the water for methane analysis. I have asked Terracon if they can be available to sample next Thursday. Gene, will you please ask the Singletons if we could access their water well also on the 21<sup>st</sup>, next Thursday. Would need to be in the morning. Trish or Crystal, can you be available next Thursday also?

---

**From:** Peter Pope  
**Sent:** Wednesday, August 13, 2014 9:24 AM  
**To:** Gene Ortiz  
**Cc:** Joe Cress; Darlene Wilson  
**Subject:** RE: Flash Fire 7B-10736

If we were to do this, I would want to pull the pump as well and have Terracon drop some kind of pump appropriate for sampling gas into the well. I will discuss this with folks here. Thanks,

Peter

---

**From:** Gene Ortiz  
**Sent:** Wednesday, August 13, 2014 9:20 AM  
**To:** Peter Pope  
**Cc:** Joe Cress; Darlene Wilson  
**Subject:** FW: Flash Fire 7B-10736

This morning I called Cody Murray to ask for an approximate time period the water well would be operational, he stated he had no idea. I also asked if it was possible if he could have someone pull the pump off so we could get samples by dropping a bailer, he said the wellhead would have to be pulled off and we would have to talk to his lawyer, Chris Hamilton, (214) 244-4943, about doing that.

---

**From:** Gene Ortiz  
**Sent:** Tuesday, August 12, 2014 4:05 PM  
**To:** Peter Pope  
**Cc:** Joe Cress; Darlene Wilson; Madelyn Flannagan; Art Correa; Michael Leckie  
**Subject:** RE: Flash Fire 7B-10736

Fairway Resources Operating, LLC  
Cook, J.T. "A" (127894)  
Well No. 1  
Palo Pinto Co. Reg. (Gas) Field

This is the one with the rotten egg odor. Debbie inspected this lease initially on August 4, 2014. Another inspection was conducted on August 5, 2014. On August 8, high winds allowed the egg smell to be detected, further investigation of the well showed bubbling water from recent rains in the water pooled in the casing wellhead. The same odor and gas leak were noted during the inspection on August 11. Previously, this gas well has not been known to produce sour gas.

I spoke with Cody Murray. At this time they do not have any current plans to get the Murray WW up and running. He stated he just got out of the hospital on Friday and has Dr. appointments to attend to. He did mention we may be able to get some water samples from the electric water heater which is right after the pressure tank.

I have also included information on another water well located approximately 1 mile south of the Murray WW.

Forrest Henderson

(Unknown house number) Rambling Road – Located south of Rambling Road.

~1 mile south of the Murray WW

This well was drilled about 30 years ago to a TD of at least 280' with unknown casing records. A submersible pump was installed about 3 or 4 years ago by Henry Erwin Water Well Drilling (940) 507-0685. Forrest Henderson stated that this water well has never really been used, but they were planning to hook this water well up to a new house currently being built. Every few months Forrest Henderson, who currently lives in SW Weatherford, will turn on the water to flush out the pipe. Nothing unusual was noticed by Forrest Henderson the last time he flushed the water out. He also did not know if there was an address for the location of the water well. I could not locate Forrest Henderson on the tax records.

Directions – Oran – Go north out of Oran to the 'T' intersection of Rambling Road. T/R, go past the old bridge approximately 300 feet, there will be a gate on the right (south) side of Rambling Road.

---

**From:** Peter Pope

**Sent:** Tuesday, August 12, 2014 2:32 PM

**To:** Gene Ortiz

**Cc:** Joe Cress; Madelyn Flannagan; Art Correa; Michael Leckie

**Subject:** RE: Flash Fire 7B-10736

Yes. I want to get samples collected as soon as possible. Madelyn is working on summarizing the inspection reports for water wells and leases. Based on this information we will make a decision about which water wells to sample, and then mobilize Terracon. I saw in an earlier email that one of the production wells was leaking gas from production casinghead that smelled like rotten eggs. Is that gas well known to produce sour gas?

---

**From:** Gene Ortiz

**Sent:** Tuesday, August 12, 2014 2:19 PM

**To:** Peter Pope

**Cc:** Joe Cress

**Subject:** RE: Flash Fire 7B-10736

Peter,

Sam Birdwell and Debbie Garcia inspected the Singleton residence earlier today. Sam pulled a Drager reading from the bathroom faucet, recorded 6 ppm H2S.



Here are the photos of the Murray WW taken by Debbie on 8/2 during the initial inspection. As of now, the WW is not in an operable state. Would you like us to contact Mr. Murray to inquire when/if they will repair their water well so we can pull samples?

Mr. Cheever mentioned to Debbie that he has the water filter with residual water. Do we want to collect that?

---

**From:** Peter Pope  
**Sent:** Tuesday, August 12, 2014 12:00 PM  
**To:** Gene Ortiz  
**Cc:** Joe Cress  
**Subject:** RE: Flash Fire 7B-10736

Is there going to be another inspection of Singleton? It would be good to sample Singleton and Murray water wells at the same time. Someone needs to access the Murray water well to see if it works. Not sure what to do about that. Perhaps Mr. Cheever could help since he has been talking the Murrays?

---

**From:** Gene Ortiz  
**Sent:** Tuesday, August 12, 2014 11:46 AM  
**To:** Peter Pope  
**Cc:** Joe Cress  
**Subject:** FW: Flash Fire 7B-10736

Peter,

Debbie was contacted by Ed Cheever, the State Fire Inspector over the Murray WW incident.

---

**From:** Debbie Garcia  
**Sent:** Tuesday, August 12, 2014 11:15 AM  
**To:** Gene Ortiz  
**Cc:** Darlene Wilson; Crystal Denson  
**Subject:** Flash Fire 7B-10736

The following email is in regards to a phone call from Ed Cheever, Texas Fire Marshall Office Fire Investigator (512) 417-7165

Also note that Cody and his family is staying with the sister. He has his phone with him (940)682-1107. Will attempt to call after inspection with Sam Birdwell at Singleton residence

CHRISTI CRADDICK, CHAIRMAN  
DAVID PORTER, COMMISSIONER  
BARRY T. SMITHERMAN, COMMISSIONER



GIL BUJANO, P.E.  
DIRECTOR, OIL AND GAS DIVISION  
D. W. -JOE- CRESS  
DISTRICT DIRECTOR

# RAILROAD COMMISSION OF TEXAS

## OIL AND GAS DIVISION

August 18, 2014

Unidentified Operator

### INITIAL REPORT

**Murray, Cody Complaint No. 7B-10736**

Murray Water Well Lease

Palo Pinto County, Texas

Job No. 14-9803

On August 2, 2014, Railroad Commission of Texas District 7B Office was contacted by Cody Murray concerning operations on the subject lease. Mr. Murray's concern was a flash fire originating from his water well possibly caused by oil and gas activities. On August 2, 2014 a joint-inspection of the lease was conducted by Debbie Garcia, Palo Pinto County Fire Marshall Larry O'Neil, Palo Pinto County Fire Investigator Carey McAliley and Cody Murray's brother-in-law George Hodges. During the inspection, the following were observed:

According to Mr. Hodges, Cody Murray's daughter informed her father, Cody Murray, and mother, Ashley that water was bubbling out of the water well and flowing out of the water well house. The water to the home and yard were turned off by Ashley. Ashley told Cody Murray and James, Cody Murray's father-in-law, that water was bubbling and gas was venting at the water well house. When Cody Murray and James went to investigate the water well house, the auto switch to the after pump kicked on and ignited the flash fire. Cody Murray, Ashley, their daughter and James were taken to area hospitals with injuries. Mr. Hodges was unaware of any water issues prior to the flash fire.

All oil and gas wells within a ½ mile radius were inspected, and no bradenhead pressure was observed on any of the wells. A records search conducted did not uncover any improperly plugged wells within a ½ mile radius. Inspections conducted at plugged well locations did not detect pollution, leaking gas or anything unusual. The complainant is advised that RRC contractor Terracon plans pull water and gas samples on August 21, 2014, under RRC supervision if possible.

The complainant is advised that the Site Remediation Department continues to work alongside the District Office in determining whether this incident stemmed from oil and gas activities under the jurisdiction of the Railroad Commission.

File review is scheduled for the week of September 29, 2014. **Please direct any questions with regard to this complaint to Gene Ortiz at (325) 677-3545.**

Sincerely,

A handwritten signature in dark ink, appearing to read "Gene Ortiz", with a stylized flourish at the end.

Gene Ortiz  
Engineering Specialist

~~GO/mm~~

☒ Assistant District Director

☐ District Director

cc: Field Operations, RRC, Austin

Cody Murary  
185 Cooper Lane  
Graford, TX 76449

Peter Pope  
Site Remediation  
RRC - Austin



## RAILROAD COMMISSION OF TEXAS

Oil and Gas Division  
Compliance SectionDistrict Office  
INSPECTION REPORTD-O  
rev. 6/07JOB NO. **14-9803**  
DISTRICT **7B**OPERATOR **MURRAY PROPERTY**  
LEASE/FACILITY **MURRAY WATER WELL**  
WELL No.(s) \_\_\_\_\_  
FIELD \_\_\_\_\_  
COUNTY **PALO PINTO** ☐ COSTAL MGT AREA  
☒ COMPLAINT NO. **7B-10736**  
COMPLAINANT NAME **CODY MURRAY**  
DIRECTIONS \_\_\_\_\_LEASE/ID \_\_\_\_\_  
DRILL PMT. NO. \_\_\_\_\_  
PLANT NO. \_\_\_\_\_  
PIT PMT. NO. \_\_\_\_\_  
PIPELINE PMT NO. \_\_\_\_\_  
OTHER \_\_\_\_\_  
LE DOCKET \_\_\_\_\_  
SFP CODE \_\_\_\_\_  
SFCU CODE \_\_\_\_\_☐ MUST WITNESS  
☐ Field Initiated  
☐ Taken By  
☐ District ☐ Austin  
☒ Backcheck  
☐ Co-inspection  
☐ Sweep  
TOTAL:  
UIC WELLS INSP \_\_\_\_\_  
WELLS INSP \_\_\_\_\_  
SITES INSP \_\_\_\_\_

% TIME	UIC	ENV	SITE REM
LEGAL ENF		PRO/PROD	TERRA
SFP		OTHER	

GPS COORDINATES: ☐ NO ☒ YES LOG# \_\_\_\_\_

LAT \_\_\_\_\_ LONG \_\_\_\_\_

ACTIVITY (check appropriate boxes)			
A	<input type="checkbox"/> BLOWOUT	P	<input type="checkbox"/> OIL SPILL (NON SENS)
B	<input type="checkbox"/> COM. SURFACE DISP. FAC.	Q	<input type="checkbox"/> OIL SPILL (SENS)
C	<input type="checkbox"/> COM. DISPOSAL WELL	R	<input type="checkbox"/> PIT INSPECTION
D	<input type="checkbox"/> FLARE/VENT	S	<input type="checkbox"/> PLANT INSP
E	<input type="checkbox"/> DISPOSAL/INJECTION	T	<input type="checkbox"/> PLUGGING (OPER)
F	<input type="checkbox"/> DRILLING RIG	U	<input type="checkbox"/> PLUGGING (SFP)
G	<input type="checkbox"/> FIRE	V	<input type="checkbox"/> PROD WATER SPILL
H	<input type="checkbox"/> H2S COMPLIANCE INSP.	W	<input type="checkbox"/> PROD TEST
I	<input type="checkbox"/> H2S INCIDENT	X	<input type="checkbox"/> PROD/INT CASING
J	<input type="checkbox"/> HYDROCARBON STRING	Y	<input type="checkbox"/> SEAL WELL
K	<input checked="" type="checkbox"/> LEASE INSPECTION	Z	<input type="checkbox"/> SITE ASSMT (SFCU)
L	<input type="checkbox"/> MIT	AA	<input type="checkbox"/> SITE CLEAN UP SFCU
M	<input type="checkbox"/> MINOR PERMIT	BB	<input type="checkbox"/> SURFACE CASING
N	<input type="checkbox"/> OFFICE	CC	<input type="checkbox"/> WASTE HAULER
O	<input type="checkbox"/> OTHER		

FIELD INSPECTION STATUS		COMPLIANCE		Prev	New	Total
		yes	no	viols.	viols.	viols.
SWR 2	Access to Property	<input checked="" type="checkbox"/>	<input type="checkbox"/>			
SWR 3	Signs	<input type="checkbox"/>	<input type="checkbox"/>			
SWR 8	Water Protection	<input type="checkbox"/>	<input type="checkbox"/>			
SWR 9	Disposal Wells	<input type="checkbox"/>	<input type="checkbox"/>			
SWR 13	Casing/Cementing	<input type="checkbox"/>	<input type="checkbox"/>			
SWR 14(B)(2)	Inactive wells	<input type="checkbox"/>	<input type="checkbox"/>			
SWR 17	Pressure on Bradenhead	<input type="checkbox"/>	<input type="checkbox"/>			
SWR 21	Firewalls	<input type="checkbox"/>	<input type="checkbox"/>			
SWR 22	Protection of Birds	<input type="checkbox"/>	<input type="checkbox"/>			
SWR 27	Gas Metering	<input type="checkbox"/>	<input type="checkbox"/>			
SWR 32	Flaring/Venting	<input type="checkbox"/>	<input type="checkbox"/>			
SWR 36	Hydrogen Sulfide	<input type="checkbox"/>	<input type="checkbox"/>			
SWR 46	Injection Wells	<input type="checkbox"/>	<input type="checkbox"/>			
SWR 91	Oil Spill Clean-up	<input type="checkbox"/>	<input type="checkbox"/>			
OTHER		<input type="checkbox"/>	<input type="checkbox"/>			
OTHER		<input type="checkbox"/>	<input type="checkbox"/>			

Comments:

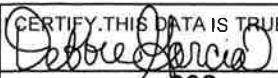
**WATER WELL HOUSE**  
**N32.993143 W98.146224****JOINT INSPECTION WITH SAM BIRDWELL FOR FLIR CAMERA AND COLORMETRIC TUBE TESTING OF H2S**  
**NO H2S DETECTED. SEE SAM BIRDWELL REPORT FOR VIDEOS.****VIDEOS WERE TAKEN OF WATER WELL HOUSE AND WATER WELL ASSEMBLY. SEE SAM BIRDWELL**  
**REPORT FOR DETAILS.**CERTIFY THIS DATA IS TRUE AND COMPLETE:  
  
TECH NO. **608** DATE **08/13/14** START: **95,274** TIME **1330** LUNCH **---** (MIN)  
END: **95,275** **1400** ☐ Job InterruptOFFICE REVIEW  
BY \_\_\_\_\_  
DATE \_\_\_\_\_

RAILROAD COMMISSION OF TEXAS  
Oil and Gas Division  
Compliance Section

District Office  
INSPECTION REPORT  
ATTACHMENT SHEET

D-A  
rev. 5/06

JOB NO. 14-9803

DISTRICT 7B

OPERATOR MURRAY PROPERTY

LEASE/FACILITY#

LEASE/FACILITY MURRAY WATER WELL

COUNTY PALO PINTO

COMPLAINT NAME CODY MURRAY

COMPLAINT NO. 7B-10736

CATTLE KEPT IN SMALL CORRAL BEHIND WATER WELL HOUSE ARE NOT PRESENT. OPEN GATE TO BACK BACK PASTURE WHICH HAS ACCESS TO TWO KNOWN STOCK TANKS. ALSO PRESENT WERE TWO CATS AND A DOG. A LARGE KIDDIE POOL AT FRONT OF HOME IS CURRENTLY BEING USED AS A WATER SOURCE FOR THESE ANIMALS.

NO H2S DETECTED ON LOCATION. SEE SAM BIRDWELL REPORT FOR DETAILS

CERTIFY THIS DATA IS TRUE AND COMPLETE:

TECH NO. 608

DATE 8/13/2014

Page 2 of 2

OFFICE REVIEW

BY

DATE

## RAILROAD COMMISSION OF TEXAS

Oil and Gas Division

Compliance Section

District Office  
INSPECTION REPORT

D-O

rev. 6/07

JOB NO. 2014 - 9803-00

DISTRICT 7B

OPERATOR **MORRAY PROPERTIES**  
 LEASE/FACILITY **MURRAY WATER WELL**  
 WELL No.(s) \_\_\_\_\_  
 FIELD \_\_\_\_\_  
 COUNTY **PALO PINTO** ☐ COSTAL MGT AREA  
☒ COMPLAINT NO. **7B - 10736**

COMPLAINANT NAME \_\_\_\_\_

DIRECTIONS \_\_\_\_\_

LEASE/ID \_\_\_\_\_  
 DRILL PMT. NO. \_\_\_\_\_  
 PLANT NO. \_\_\_\_\_  
 PIT PMT. NO. \_\_\_\_\_  
 PIPELINE PMT NO. \_\_\_\_\_  
 OTHER \_\_\_\_\_  
 LE DOCKET \_\_\_\_\_  
 SFP CODE \_\_\_\_\_  
 SFCU CODE \_\_\_\_\_

☐ MUST WITNESS☐ Field Initiated☐ Taken By \_\_\_\_\_☐ District ☐ Austin☒ Backcheck☐ Co-inspection☐ Sweep

TOTAL:

UIC WELLS INSP \_\_\_\_\_

WELLS INSP **1**SITES INSP **1**

VIDEO SERIES: 2014\_08\_13\_FLIR

VIDEOS: SEE COMMENTS

GPS COORDINATES: ☐ NO ☐ YES LOG# **WELL**LAT **N32.993381** LONG **W98.146630**

ACTIVITY (check appropriate boxes)

A <input type="checkbox"/> BLOWOUT	P <input type="checkbox"/> OIL SPILL (NON SEN)
B <input type="checkbox"/> COM. SURFACE DISP. FAC.	Q <input type="checkbox"/> OIL SPILL (SENS)
C <input type="checkbox"/> COM. DISPOSAL WELL	R <input type="checkbox"/> PIT INSPECTION
D <input type="checkbox"/> FLARE/VENT	S <input type="checkbox"/> PLANT INSP
E <input type="checkbox"/> DISPOSAL/INJECTION	T <input type="checkbox"/> PLUGGING (OPER)
F <input type="checkbox"/> DRILLING RIG	U <input type="checkbox"/> PLUGGING (SFP)
G <input type="checkbox"/> FIRE	V <input type="checkbox"/> PROD WATER SPILL
H <input type="checkbox"/> H2S COMPLIANCE INSP.	W <input type="checkbox"/> PROD TEST
I <input type="checkbox"/> H2S INCIDENT	X <input type="checkbox"/> PROD/INT CASING
J <input type="checkbox"/> HYDROCARBON STRING	Y <input type="checkbox"/> SEAL WELL
K <input checked="" type="checkbox"/> LEASE INSPECTION	Z <input type="checkbox"/> SITE ASSMT (SFCU)
L <input type="checkbox"/> MIT	AA <input type="checkbox"/> SITE CLEAN UP SFCU
M <input type="checkbox"/> MINOR PERMIT	BB <input type="checkbox"/> SURFACE CASING
N <input type="checkbox"/> OFFICE	CC <input type="checkbox"/> WASTE HAULER
O <input type="checkbox"/> OTHER	

## FIELD INSPECTION STATUS

		COMPLIANCE		Prev viols	New viols	Total viols.
		yes	no			
SWR 2	Access to Property	<input checked="" type="checkbox"/>	<input type="checkbox"/>	0	0	0
SWR 3	Signs	<input type="checkbox"/>	<input type="checkbox"/>			
SWR 8	Water Protection	<input type="checkbox"/>	<input type="checkbox"/>			
SWR 9	Disposal Wells	<input type="checkbox"/>	<input type="checkbox"/>			
SWR 13	Casing/Continging	<input type="checkbox"/>	<input type="checkbox"/>			
SWR 14(B)(2)	Inactive wells	<input type="checkbox"/>	<input type="checkbox"/>			
SWR 17	Pressure on Bradenhead	<input type="checkbox"/>	<input type="checkbox"/>			
SWR 21	Firewalls	<input type="checkbox"/>	<input type="checkbox"/>			
SWR 22	Protection of Birds	<input type="checkbox"/>	<input type="checkbox"/>			
SWR 27	Gas Metering	<input type="checkbox"/>	<input type="checkbox"/>			
SWR 32	Flaring/Venting	<input type="checkbox"/>	<input type="checkbox"/>			
SWR 36	Hydrogen Sulfide	<input type="checkbox"/>	<input type="checkbox"/>			
SWR 46	Injection Wells	<input type="checkbox"/>	<input type="checkbox"/>			
SWR 91	Oil Spill Clean-up	<input type="checkbox"/>	<input type="checkbox"/>			
OTHER		<input type="checkbox"/>	<input type="checkbox"/>			
OTHER		<input type="checkbox"/>	<input type="checkbox"/>			

Comments: **JOINT INSPECTION WITH RRC INSPECTOR, DEBBIE GARCIA****SWR 2: ACCESS IS AVAILABLE**

**FLIR CAMERA VIDEOS OF THE INSIDE OF THE WELL PUMP HOUSE WERE OBTAINED DURING THIS INSPECTION. NO VISIBLE VENTING OF GAS WAS OBSERVED FROM THE WATER WELL OR PUMP HOUSE.**

**WELL WAS SHUT DOWN. NO ELECTRICITY WAS AVAILABLE TO THE WATER WELL DUE TO THE RECENT FIRE.**

**VIDEO SERIES: MOV 0547, 0548, 0549, 0550, 0551, 0552, 0553**

I CERTIFY THIS DATA IS TRUE AND COMPLETE:

TECH NO. **163** DATE **08/13/14**

START:

MILEAGE

**76,807**

TIME

**1330**

LUNCH

**60 (MIN)**

END:

**76,952****1700**☐ Job Interrupt

OFFICE REVIEW

BY \_\_\_\_\_

DATE \_\_\_\_\_



## RAILROAD COMMISSION OF TEXAS

Oil and Gas Division  
Compliance SectionDistrict Office  
INSPECTION REPORTD-O  
rev. 6/07JOB NO. **14- 9749-00**  
DISTRICT **7B**OPERATOR **MURRAY PROPERTY**  
LEASE/FACILITY **MURRAY WATER WELL**  
WELL No.(s) \_\_\_\_\_  
FIELD \_\_\_\_\_  
COUNTY **PALO PINTO** ☐ COSTAL MGT AREA  
☒ COMPLAINT NO. **7B-**  
COMPLAINANT NAME **CODY MURRAY**  
DIRECTIONS \_\_\_\_\_  
\_\_\_\_\_  
\_\_\_\_\_  
\_\_\_\_\_  
\_\_\_\_\_LEASE/ID \_\_\_\_\_  
DRILL PMT. NO. \_\_\_\_\_  
PLANT NO. \_\_\_\_\_  
PIT PMT. NO. \_\_\_\_\_  
PIPELINE PMT NO. \_\_\_\_\_  
OTHER \_\_\_\_\_  
LE DOCKET \_\_\_\_\_  
SFP CODE \_\_\_\_\_  
SFCU CODE \_\_\_\_\_☐ MUST WITNESS  
☐ Field Initiated  
☒ Taken By  
☒ District ☐ Austin  
☐ Backcheck  
☐ Co-inspection  
☐ Sweep  
TOTAL:  
UIC WELLS INSP \_\_\_\_\_  
WELLS INSP \_\_\_\_\_  
SITES INSP \_\_\_\_\_

% TIME	UIC	ENV	SITE REM
LEGAL ENF	PRO/PROD	TERRA	
SFP	OTHER		

GPS COORDINATES: ☐ NO ☒ YES LOG# \_\_\_\_\_

LAT \_\_\_\_\_ LONG \_\_\_\_\_

## ACTIVITY (check appropriate boxes)

A <input type="checkbox"/> BLOWOUT	P <input type="checkbox"/> OIL SPILL (NON SEN)
B <input type="checkbox"/> COM. SURFACE DISP. FAC.	Q <input type="checkbox"/> OIL SPILL (SENS)
C <input type="checkbox"/> COM. DISPOSAL WELL	R <input type="checkbox"/> PIT INSPECTION
D <input type="checkbox"/> FLARE/VENT	S <input type="checkbox"/> PLANT INSP
E <input type="checkbox"/> DISPOSAL/INJECTION	T <input type="checkbox"/> PLUGGING (OPER)
F <input type="checkbox"/> DRILLING RIG	U <input type="checkbox"/> PLUGGING (SFP)
G <input type="checkbox"/> FIRE	V <input type="checkbox"/> PROD WATER SPILL
H <input type="checkbox"/> H2S COMPLIANCE INSP.	W <input type="checkbox"/> PROD TEST
I <input type="checkbox"/> H2S INCIDENT	X <input type="checkbox"/> PROD/INT CASING
J <input type="checkbox"/> HYDROCARBON STRING	Y <input type="checkbox"/> SEAL WELL
K <input checked="" type="checkbox"/> LEASE INSPECTION	Z <input type="checkbox"/> SITE ASSMT (SFCU)
L <input type="checkbox"/> MIT	AA <input type="checkbox"/> SITE CLEAN UP SFCU
M <input type="checkbox"/> MINOR PERMIT	BB <input type="checkbox"/> SURFACE CASING
N <input type="checkbox"/> OFFICE	CC <input type="checkbox"/> WASTE HAULER
O <input type="checkbox"/> OTHER	

## FIELD INSPECTION STATUS

		COMPLIANCE		Prev	New	Total
		yes	no	viols.	viols.	viols.
SWR 2	Access to Property	<input checked="" type="checkbox"/>	<input type="checkbox"/>			
SWR 3	Signs	<input type="checkbox"/>	<input type="checkbox"/>			
SWR 8	Water Protection	<input type="checkbox"/>	<input type="checkbox"/>			
SWR 9	Disposal Wells	<input type="checkbox"/>	<input type="checkbox"/>			
SWR 13	Casing/Cementing	<input type="checkbox"/>	<input type="checkbox"/>			
SWR 14(B)(2)	Inactive wells	<input type="checkbox"/>	<input type="checkbox"/>			
SWR 17	Pressure on Bradenhead	<input type="checkbox"/>	<input type="checkbox"/>			
SWR 21	Firewalls	<input type="checkbox"/>	<input type="checkbox"/>			
SWR 22	Protection of Birds	<input type="checkbox"/>	<input type="checkbox"/>			
SWR 27	Gas Metering	<input type="checkbox"/>	<input type="checkbox"/>			
SWR 32	Flaring/Venting	<input type="checkbox"/>	<input type="checkbox"/>			
SWR 36	Hydrogen Sulfide	<input type="checkbox"/>	<input type="checkbox"/>			
SWR 46	Injection Wells	<input type="checkbox"/>	<input type="checkbox"/>			
SWR 91	Oil Spill Clean-up	<input type="checkbox"/>	<input type="checkbox"/>			
OTHER		<input type="checkbox"/>	<input type="checkbox"/>			
OTHER		<input type="checkbox"/>	<input type="checkbox"/>			

Comments: \_\_\_\_\_

**WATER WELL HOUSE****N32.993143 W98.146224**

## AT LOCATION:

**PALO PINTO CO FIRE MARSHALL LARRY ONEIL****PALO PINTO FIRE INVESTIGATOR CAREY MCALILEY****BROTHER IN LAW TO CODY MURRAY GEORGE HODGES**

CERTIFY THIS DATA IS TRUE AND COMPLETE:

TECH NO. **608** DATE **08/02/14**START: \_\_\_\_\_  
END: \_\_\_\_\_MILEAGE  
**94,170**  
**94,207**TIME  
**1645**  
**1900**LUNCH  
--- (MIN)  
☐ Job Interrupt

## OFFICE REVIEW

BY \_\_\_\_\_  
DATE \_\_\_\_\_

RAILROAD COMMISSION OF TEXAS  
Oil and Gas Division  
Compliance Section

District Office  
INSPECTION REPORT  
ATTACHMENT SHEET

D-A  
rev. 5/06

JOB NO. 14-

DISTRICT 7B

OPERATOR MURRAY PROPERTY

LEASE/FACILITY#

LEASE/FACILITY MURRAY WATER WELL

COUNTY PALO PINTO

COMPLAINT NAME CODY MURRAY

COMPLAINT NO. 7B-

CONTACTED BY DAVID MORELAND VIA PHONE CALL AT 1645 OF A WATERWELL THAT WAS LEAKING GAS AND THEN CAUSED A FLASH FIRE INJURING LANDOWNERS

MET WITH GEORGE HODGES (940)229-1380 AT ORAN AT 1745 WHO DROVE TO LOCATION. AT TIME OF INSPECTION PALO PINTO FIRE MARSHALL LARRY ONEIL AND INVESTIGATOR CARY MCALILEY WERE ALSO ON LOCATION. WATER WELL HOUSE WAS TAPED OFF. ALL POWER WITH THE EXCEPTION OF THAT TO THE DEEP FREEZER HAD BEEN SHUT OFF TO WELL HOUSE.

ACCORDING TO MR ONEIL FLASH FIRE WAS CALLED IN AT 15:52. 3 ADULTS AND 1 CHILD INJURED.  
STATUS OF INJURED:

CODY MURRAY - FLOWN OUT TO UNKNOWN HOSPITAL

JAMES (FATHER IN LAW) - DRIVEN BY PRIVATE CAR TO PALO PINTO CO HOSPITAL

ALLYSA (4 YR OLD) AND ASHLEY (MOTHER) - TAKEN BY AMBULANCE TO PALO PINTO CO HOSPITAL

MR ONEIL, MR MCALILEY, AND MR HODGES WERE ALL AWARE OF MR SINGLETON'S WATER WELL/ GAS ISSUES PRIOR TO MY ARRIVAL ON LOCATION AS MR ONEIL WAS ONE TO TELL ME THAT HE UNDERSTOOD THIS WAS NOT THE FIRST GAS/WATER WELL PROBLEM IN AREA.

\*\*SPECIAL NOTE: SINGLETON WATER WELL IS STILL UNDER INVESTIGATION AT TIME OF INSPECTION

STORY OF INCIDENT ACCORDING TO MR HODGES;

WATER WAS BUBBLING OUT OF WATER WELL AND FLOWING OUT OF WATER WELL HOUSE. ALLYSA TOLD HER FATHER AND MOTHER. ASHLEY TURNED OFF WATER IN HOME AND YARD. ASHLEY TOLD CODY AND JAMES OF WATER AND VENTING GAS AT WATER WELL HOUSE. WHEN CODY AND JAMES WENT TO INVESTIGATE GAS, AUTO SWITCH TO WATER PUMP KICKED ON AND IGNITED FLASH.

FLASH FIRE CAUGHT ONTO WALL CLOSEST TO WATER WELL OUTLET, PLASTIC BOTTLES ON TOP OF DEEP FREEZER AND SOME PLASTIC BAGGING LEFT AROUND WATER WELL HOUSE.

SEE PHOTOS 2211-2225

GRID #1 SHOWS WELLS WITHIN A 1/4, 1/2, 3/4 AND MILE RADIUS.

GRID #2 SHOWS LOCATION OF WATER WELL ON XMAPS

GRID #3 SHOWS WATER WELL IN REFERENCE TO HOME.

DIRECTIONS TO HOME: AT ORAN HEAD NORTH ON ORAN RD, AT 'T' ON RAMBLING ROAD, TURN RIGHT AT COOK RD TURN LEFT, THEN LEFT ON COOPER LN, FIRST HOME ON LEFT SIDE, GREEN 'M' GATE

CERTIFY THIS DATA IS TRUE AND COMPLETE:

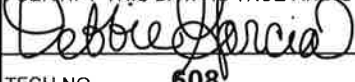

TECH NO. 608

DATE 8/2/2014

Page 2 of 5

OFFICE REVIEW

BY

DATE

RAILROAD COMMISSION OF TEXAS  
Oil and Gas Division  
Compliance Section

District Office  
INSPECTION REPORT  
ATTACHMENT SHEET

D-A  
rev. 5/06

JOB NO. 14-

DISTRICT 7B

OPERATOR MURRAY PROPERTY

LEASE/FACILITY#

LEASE/FACILITY MURRAY WATER WELL

COUNTY PALO PINTO

COMPLAINT NAME CODY MURRAY

COMPLAINT NO. 7B-

MR HODGES WILL BE THE MAIN CONTACT FOR INCIDENT SINCE FAMILY CONDITION IS UNDETERMINED AT MOMENT.

MR HODGES IS UNAWARE OF ANY WATER ISSUES PRIOR TO INCIDENT AND IS UNABLE TO POINT OUT LOCATION OF SEPTIC SYSTEM.

**\*\*UPDATED\*\*** UPON INSPECTION OF 1/2 MILE WELL OF INCIDENT, RICHARD SINGLETON AND WIFE APPROACHED MYSELF. THEY STATED THE WIFE AND DAUGHTER HAVE BEEN RELEASED BUT THE HUSBAND AND GRANDFATHER REMAIN AT THE HOSPITAL. MR SINGLETON STATED THAT HE KNEW OF A BAD FRACK JOB DONE ABOUT 20 OR SO YEARS AGO AT HIS BROTHERS PROPERTY JUST NORTH OF THE MURRAY PROPERTY ABOVE THE CREEK. TWO LEASES FIT THAT DESCRIPTION RRC# 030438 AND #088418. NEITHER LEASE HAS BEEN INVESTIGATED WITH SINGLETON WATERWELL COMPLAINT PRIOR. MR SINGLETON BELIEVES HIS WELL DIDN'T CATCH FIRE SIMILAR TO MURRAY FAMILY BECAUSE HIS WATER WELL HOUSE HAS A BREEZE WAY WHEREAS MR MURRAY'S IS AN INSULATED AND ENCLOSED SHED WHICH ALLOWED THE GAS TO BUILD UP.

TWO UNIDENTIFIED TRUCKS WERE ON LOCATION. ONE JUST AS I DROVE UP LEFT BUT WAS SPEAKING TO THE FIRE MARSHALL PRIOR TO LEAVING AND ANOTHER AS I WAS LEAVING LOCATION DROVE UP AND SPOKE TO MR HODGES.

AS OF NOW, NO KNOWN MEDIA IS ON LOCATION.

MR HODGES AND SINGLETON FAMILY WILL BE LOCKING GATES AND CHECKING ON PROPERTY WHILE MURRAY FAMILY IS AWAY.

ALL ACTIVE WELLS WITHIN A 1/2 MILE RADIUS (WITH COMPLETE LEASE INSPECTIONS) WILL BE CONDUCTED. SEE FOLLOWING REPORTS.

CERTIFY THIS DATA IS TRUE AND COMPLETE:

TECH NO. 608

DATE 8/2/2014

Page 2 of 5

OFFICE REVIEW

BY

DATE



RAILROAD COMMISSION OF TEXAS

Oil & Gas Division

Compliance Section

Job No 14-

District 7B

OPERATOR MURRAY PROPERTY

LEASE/FACILITY \_\_\_\_\_

LEASE/FACILITY MURRAY WATER WELL

PLANT NO \_\_\_\_\_

WELL NO \_\_\_\_\_

DRILL PMT NO \_\_\_\_\_

FIELD \_\_\_\_\_

PIT PERMIT NO \_\_\_\_\_

COUNTY PALO PINTO

COMPLAINT NUMBER 7B-

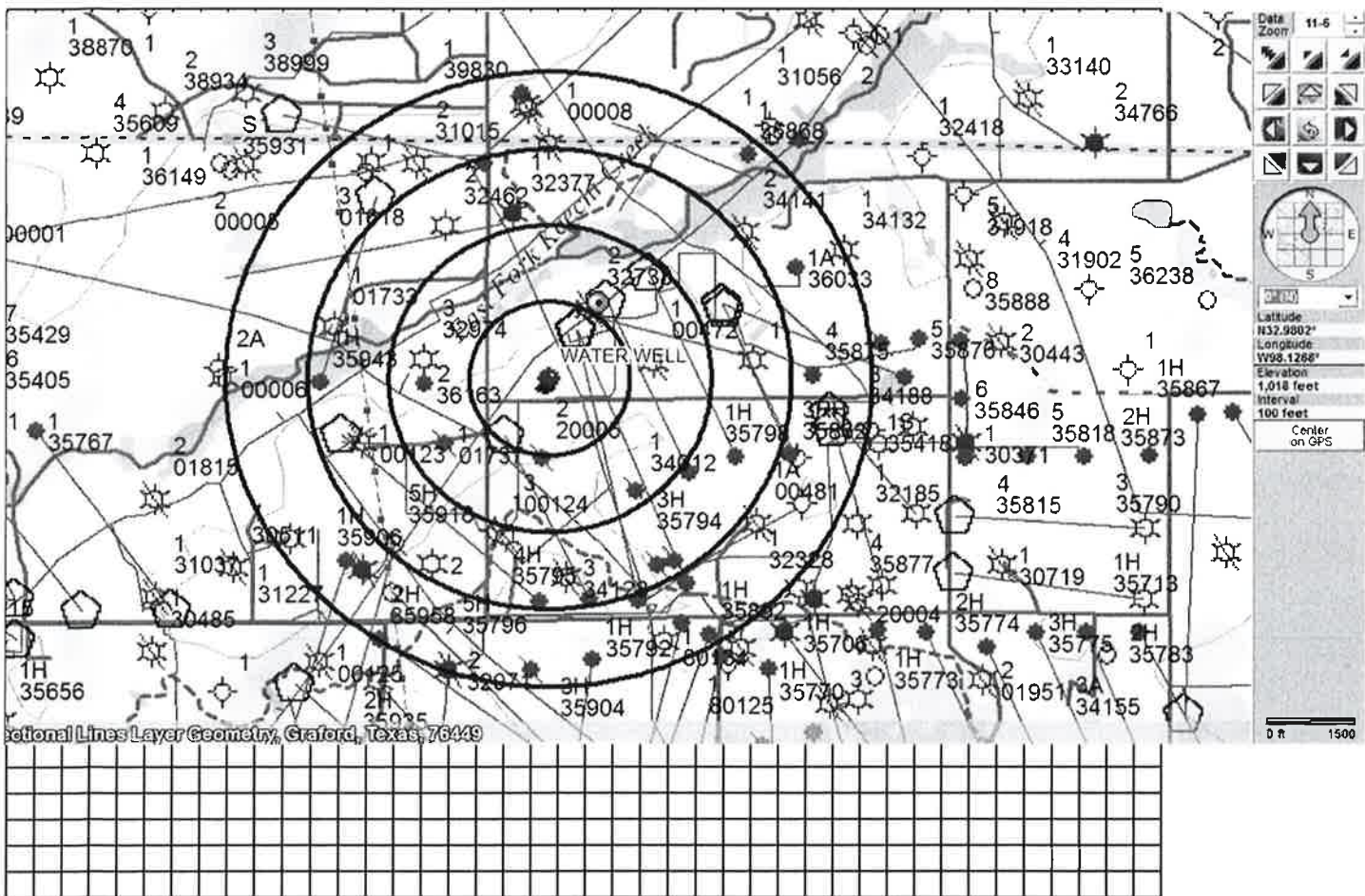

I certify this data is true and complete:

*Debbie Garcia*

Tech No. 608 Date: 08/02/14 Page 3 of 5

Office Review

By: \_\_\_\_\_

Date: \_\_\_\_\_



Oil & Gas Division  
Compliance Section

Job No 14-  
District 7B

OPERATOR	<b>MURRAY PROPERTY</b>	LEASE/FACILITY	
LEASE/FACILITY	<b>MURRAY WATER WELL</b>	PLANT NO	
WELL NO		DRILL PMT NO	
FIELD		PIT PERMIT NO	
COUNTY	<b>PALO PINTO</b>	COMPLAINT NUMBER	<b>7B-</b>

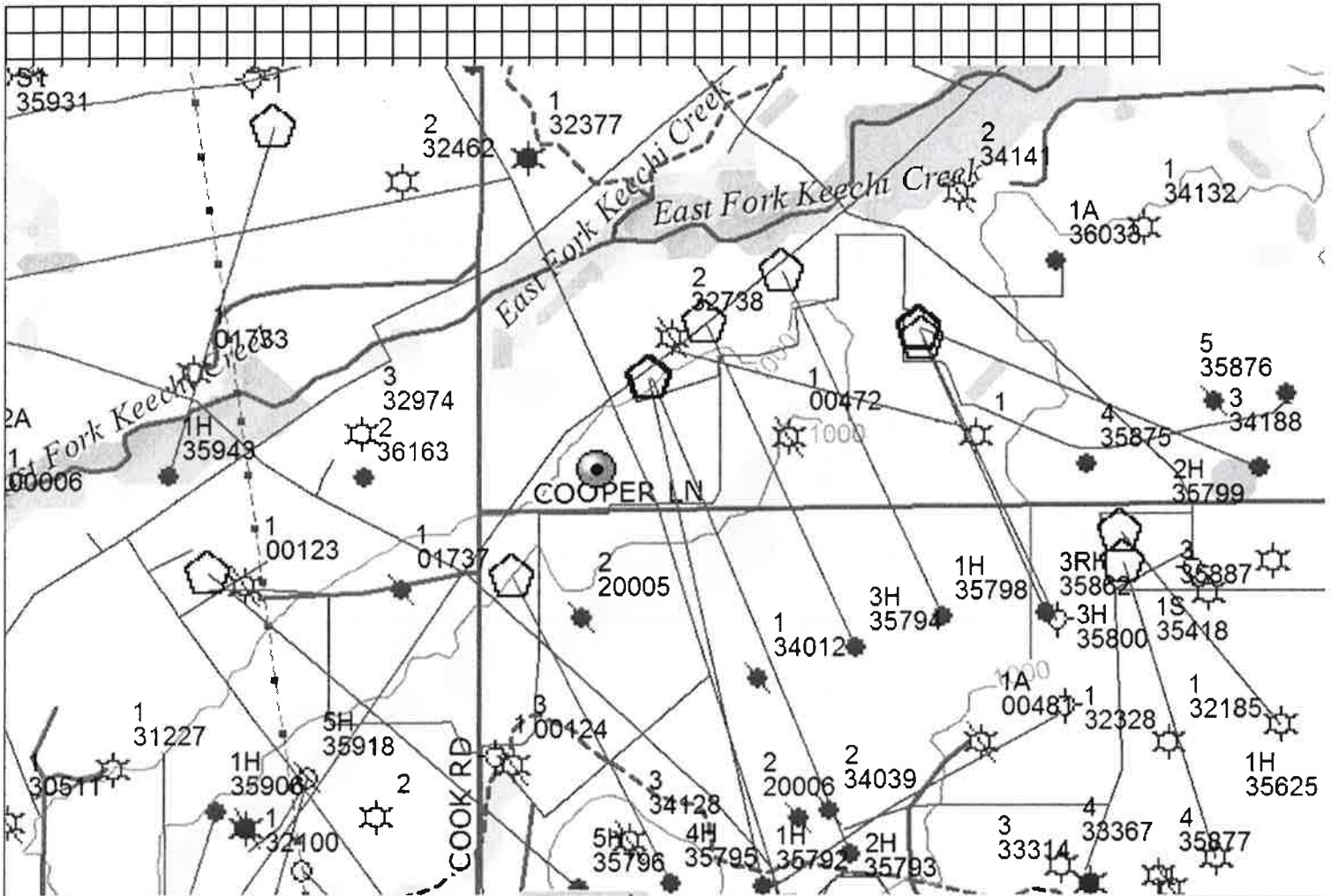

Debbie Garcia

Tech No. **608** Date: **08/02/14** Page **4** of **5**

By: \_\_\_\_\_  
Date: \_\_\_\_\_

**RAILROAD COMMISSION OF TEXAS**

Oil & Gas Division  
Compliance Section

Job No 14-  
District 7B

OPERATOR MURRAY PROPERTY LEASE/FACILITY \_\_\_\_\_  
LEASE/FACILITY MURRAY WATER WELL PLANT NO \_\_\_\_\_  
WELL NO \_\_\_\_\_ DRILL PMT NO \_\_\_\_\_  
FIELD \_\_\_\_\_ PIT PERMIT NO \_\_\_\_\_  
COUNTY PALO PINTO COMPLAINT NUMBER 7B-

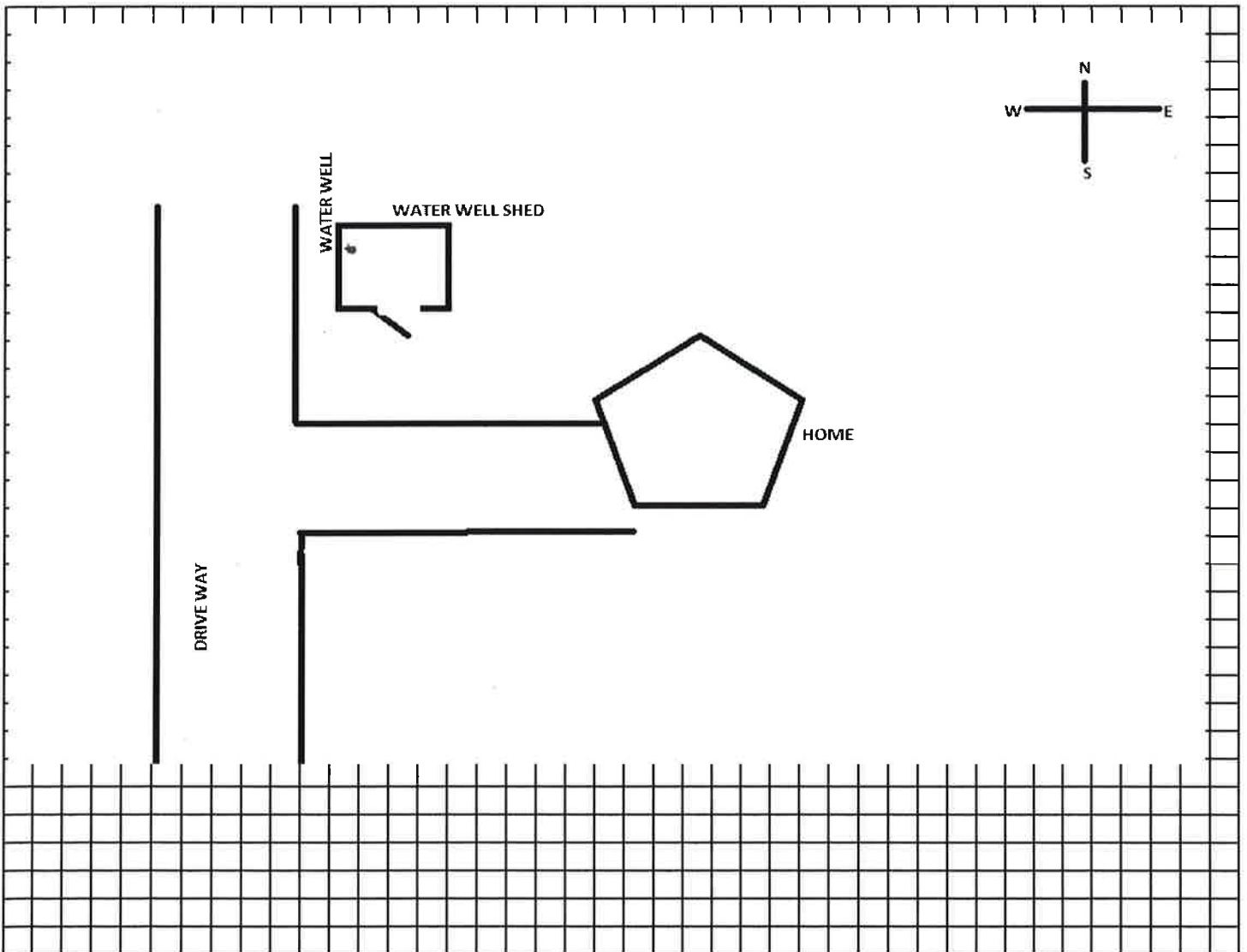

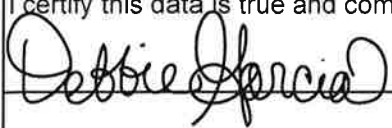
I certify this data is true and complete:  
  
Tech No. 608 Date: 08/02/14 Page 5 of 5

Office Review  
By: \_\_\_\_\_  
Date: \_\_\_\_\_

## RAILROAD COMMISSION OF TEXAS

Oil and Gas Division  
Compliance Section

DISTRICT OFFICE

## NOTIFICATION FORM

**D-N**  
rev. 03/00JOB NO. 2014-9803DISTRICT 7BNOTIFICATION: ☐ INDUSTRY ☒ PUBLIC☒ CALL ☐ LETTER ☐ OTHERNAME CODY MURRAYDATE 08/02/14TIME 16:26TITLE/CO. LANDOWNERPHONE # (940) 682-1107OPERATOR UNIDENTIFIED

LEASE/ID \_\_\_\_\_

☐ MUST WITNESSLEASE/FACILITY MURRAY WATER WELL

PLANT NO. \_\_\_\_\_

☒ TAKEN:

WELL No.(s) \_\_\_\_\_

DRILL PMT.NO. \_\_\_\_\_

BY CRESSJ

FIELD \_\_\_\_\_

PIT PMT.NO. \_\_\_\_\_

DATE 08/04/14COUNTY PALO PINTO

PIPELINE PMT.NO. \_\_\_\_\_

☐ AUSTIN ☒ DISTRICT☒ COMPLAINT NO. 10736OTHER 7B-10736

RETURN BY:

COMPLAINANT NAME CODY MURRAY

LE DOCKET NO. \_\_\_\_\_

DATE 08/15/14PHONE NUMBER (940) 682-1107

SFP CODE \_\_\_\_\_

☐ BACKCHECK

SFCU CODE \_\_\_\_\_

☐ SWEEPADDRESS PO BOX 164PERRINTX76486DIRECTIONS WELL BEHIND THE HOUSE AT 185 COOPER LANE IN GRAFORD, TX.**ACTIVITY** (check approp. boxes) **H** ☐ H2S COMPLIANCE INSP.**A** ☐ BLOWOUT**I** ☐ H2S INCIDENT**P** ☐ OIL SPILL(NON-SENS. AREA)**W** ☐ PROD. TEST**B** ☐ COM.SURFACE DISP. FACILITY**J** ☐ HYDROCARBON STRG.**Q** ☐ OIL SPILL (SENS. AREA)**X** ☐ PROD./INT.CASING**C** ☐ COM.DISPOSAL WELL**K** ☒ LEASE INSPECTION**R** ☐ PIT INSPECTION**Y** ☐ SEAL WELL**D** ☐ FLARE/VENT**L** ☐ MIT**S** ☐ PLANT INS**Z** ☐ SITE ASSMT (SFCU)**E** ☐ DISPOSAL/INJECTION**M** ☐ MINOR PERMIT**T** ☐ PLUGGING (OPER.)**AA** ☐ SITE CLEAN-UP(SFCU)**F** ☐ DRILLING RIG**N** ☐ OFFICE**U** ☐ PLUGGING (SFP)**BB** ☐ SURFACE CASIN**G** ☐ FIRE**O** ☐ OTHER**V** ☐ PROD. WATER SPILL**CC** ☐ WASTE HAULERCOMMENTS: FIRE, WITH INJURIES, CAUSED BY GAS IN WATER WELLSPARK IGNITED GAS FROM A WATER WELL CAUSING A FLASH FIRE IN WHICH 4 PEOPLE WERE INJURED ACCORDING TO  
COMPLAINANT.ADDRESS OF WELL HOUSE - 185 COOPER LANE, GRAFORD, TX 76449

SCHEDULED

DATE: 08/02/14TIME: 17:00FIELD INSPECTOR: If not  
witnessed, check here, initial, date  
and return form to supervisor.

INITIALS: \_\_\_\_\_

DATE: \_\_\_\_\_

## RAILROAD COMMISSION OF TEXAS

Oil and Gas Division  
Compliance SectionDistrict Office  
INSPECTION REPORT

D-O

rev. 6/07

JOB NO. 14-10172-00  
DISTRICT 7BOPERATOR KOKOMO  
LEASE/FACILITY IDA LEWIS  
WELL No.(s) 2  
FIELD \_\_\_\_\_  
COUNTY PALO PINTO ☐ COSTAL MGT AREA  
☐ COMPLAINT NO. \_\_\_\_\_

COMPLAINANT NAME \_\_\_\_\_

DIRECTIONS \_\_\_\_\_

**RESEARCH FOR COMPLAINTS:**  
**7B-10736 & 7B-10612**LEASE/ID 101304  
DRILL PMT. NO. \_\_\_\_\_  
PLANT NO. \_\_\_\_\_  
PIT PMT. NO. \_\_\_\_\_  
PIPELINE PMT NO. \_\_\_\_\_  
OTHER \_\_\_\_\_  
LE DOCKET \_\_\_\_\_  
SFP CODE \_\_\_\_\_  
SFCU CODE \_\_\_\_\_☐ MUST WITNESS☒ Field Initiated☐ Taken By \_\_\_\_\_☐ District ☐ Austin☐ Backcheck☐ Co-inspection☐ Sweep

TOTAL:

UIC WELLS INSP \_\_\_\_\_

WELLS INSP 1

SITES INSP \_\_\_\_\_

% TIME	UIC	ENV	SITE REM
LEGAL ENF		PRO/PROD	TERRA
SFP		OTHER	

GPS COORDINATES: ☐ NO ☒ YES LOG# \_\_\_\_\_

LAT \_\_\_\_\_ LONG \_\_\_\_\_

ACTIVITY (check appropriate boxes)

A <input type="checkbox"/> BLOWOUT	P <input type="checkbox"/> OIL SPILL (NON SEN)
B <input type="checkbox"/> COM. SURFACE DISP. FAC.	Q <input type="checkbox"/> OIL SPILL (SENS)
C <input type="checkbox"/> COM. DISPOSAL WELL	R <input type="checkbox"/> PIT INSPECTION
D <input type="checkbox"/> FLARE/VENT	S <input type="checkbox"/> PLANT INSP
E <input type="checkbox"/> DISPOSAL/INJECTION	T <input type="checkbox"/> PLUGGING (OPER)
F <input type="checkbox"/> DRILLING RIG	U <input type="checkbox"/> PLUGGING (SFP)
G <input type="checkbox"/> FIRE	V <input type="checkbox"/> PROD WATER SPILL
H <input type="checkbox"/> H2S COMPLIANCE INSP.	W <input type="checkbox"/> PROD TEST
I <input type="checkbox"/> H2S INCIDENT	X <input type="checkbox"/> PROD/INT CASING
J <input type="checkbox"/> HYDROCARBON STRING	Y <input type="checkbox"/> SEAL WELL
K <input checked="" type="checkbox"/> LEASE INSPECTION	Z <input type="checkbox"/> SITE ASSMT (SFCU)
L <input type="checkbox"/> MIT	AA <input type="checkbox"/> SITE CLEAN UP SFCU
M <input type="checkbox"/> MINOR PERMIT	BB <input type="checkbox"/> SURFACE CASING
N <input type="checkbox"/> OFFICE	CC <input type="checkbox"/> WASTE HAULER
O <input type="checkbox"/> OTHER	

Comments: \_\_\_\_\_

## FIELD INSPECTION STATUS

		COMPLIANCE		Prev viols.	New viols.	Total viols.
		yes	no			
SWR 2	Access to Property	<input checked="" type="checkbox"/>	<input type="checkbox"/>			
SWR 3	Signs	<input type="checkbox"/>	<input type="checkbox"/>			
SWR 8	Water Protection	<input checked="" type="checkbox"/>	<input type="checkbox"/>			
SWR 9	Disposal Wells	<input type="checkbox"/>	<input type="checkbox"/>			
SWR 13	Casing/Cementing	<input type="checkbox"/>	<input type="checkbox"/>			
SWR 14(B)(2)	Inactive wells	<input type="checkbox"/>	<input type="checkbox"/>			
SWR 17	Pressure on Bradenhead	<input type="checkbox"/>	<input type="checkbox"/>			
SWR 21	Firewalls	<input type="checkbox"/>	<input type="checkbox"/>			
SWR 22	Protection of Birds	<input type="checkbox"/>	<input type="checkbox"/>			
SWR 27	Gas Metering	<input type="checkbox"/>	<input type="checkbox"/>			
SWR 32	Flaring/Venting	<input type="checkbox"/>	<input type="checkbox"/>			
SWR 36	Hydrogen Sulfide	<input type="checkbox"/>	<input type="checkbox"/>			
SWR 46	Injection Wells	<input type="checkbox"/>	<input type="checkbox"/>			
SWR 91	Oil Spill Clean-up	<input type="checkbox"/>	<input type="checkbox"/>			
OTHER		<input type="checkbox"/>	<input type="checkbox"/>			
OTHER		<input type="checkbox"/>	<input type="checkbox"/>			

CERTIFY THIS DATA IS TRUE AND COMPLETE:

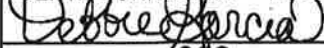
TECH NO. 608 DATE 08/11/14

START:

MILEAGE  
95,030

END:

95,030TIME  
13201340

LUNCH

(MIN)

☐ Job Interrupt

OFFICE REVIEW

BY \_\_\_\_\_

DATE \_\_\_\_\_



JOB NO. 14-

DISTRICT 7B

OPERATOR KOKOMO

LEASE/FACILITY# 101304

LEASE/FACILITY IDA LEWIS

COUNTY PALO PINTO

COMPLAINT NAME

COMPLAINT NO.

PLUGGED WELL

ENTRANCE

N32.99248 W98.142549

SWR2: ACCESS OK. EOG LEASE COMBO GIVEN

SWR3: NO SIGNS POSTED. PLUGGED WELL NO VIOLATION

AT LOCATION OF WELL ACCORDING TO GPS NO SIGNS OF CONCRETE OR POLLUTION  
GREEN VEGETATION PRESENT THROUGHOUT AREA.

SEE PHOTOS 2415 - 2417

GRAFORD EAST

2  
32738  
PLU

DELOREME

Data use subject to license.  
© Delorme, XMap®  
www.delorme.com

CERTIFY THIS DATA IS TRUE AND COMPLETE:

TECH NO. 608

DATE 8/11/2014

Page 2 of 2

OFFICE REVIEW

BY

DATE